



Ottawa County Jr. Fair

2025 HANDBOOK

Book Sponsored by:



7870 W State Rte 163
Oak Harbor, OH 43449
419-898-1971

www.ottawacountyfair.org
Find us at Ottawa County Fair on Facebook

2025 Ottawa County Jr. Fair Advisors & Mentors

Angie Rahm	Jr. Fair Board Advisor	angierahm@gmail.com
Molly Avers	Jr. Fair Board Advisor	avers.15@osu.edu
Olivia Rahm	Jr. Fair Board Mentor	
Bailey Dusseau	Jr. Fair Board Mentor	
Lauren St. Clair	Jr. Fair Board Mentor	
Taylor Lenke	Jr. Fair Board Mentor	
Madison Wolf	Jr. Fair Board Mentor	

2025 Ottawa County Jr. Fair Board and Jr. Fair Board in Training

Simon Amonette	Addy Gahler	Dean Kitzler	Karmela Neiderhouse	Brooklynn Starkey
Colleen Barron	Griffin Gahler	Kase Knecht	Alexis Perry	Erin Sutkus
Jack Barron	Lilly Gahler	Kole Knecht	Brock Perry	Amelia Tooman
Audrey Branum	Cole Griffin	Hudson Kwiatkowski	Nora Rosario	Austin Torres
Ethan Branum	Will Hartlaub	Abigail Lenke	Josh Sander	Madison Torres
Corrina Brough	Addison Hartman	Madelyn Lenke	Jaylin Smith	Austin Wolf
Courtney Chapinski	Kimber Hasselbach	Seth Lenke	Natalie Smith	Logan Wolf
Jenna Damschroder	Kalle Heins	Tucker Lenke	Caleb Soltis	Cooper Young
Kennedy Donnelly	Mya Huether	Chloe Milbrodt	Rachael Soltis	
Tait Dusseau	Wade Kapp	Cecilia Munoz	Lyla Sprague	

Mallory Amonette	Elizabeth Greener	Stella Laughlin	Zofia Matthews-Derrer	Jaxen Ruffier
Bridget Berry	Kendyll Hartlaub	Wyatt Leady	Sophia Miley	Rylan Sandrock
Erica Biggert	Chloe Hatt	Walter Leady	Corbin Miller	Nora Schiller
Anna Brewster	Zane Heschel	Kayleigh Lenke	Evelyn Miller	Emma Schlagheck
Rylie Carr	Lane Kapp	Natalie Lenke	Kinsley Moore	Lauren Smith
Makenna Carr	Cora Kapp	Addisynn Lenke	Veronica Munoz	Christian Soltis
Kayla Christiansen	Kate Kegerize	Ryker Lipstraw	Gabriela Neiderhouse	Gracelyn Soltis
Isaac Combs	Kira Kegerize	Kennedy Martikan	Gwen Pierson	Maddison Suktus
Destiny Derrick	Evelyn Kovacs	Kyleigh Martikan	Parker Riffner	Kielie Whitcum
Carrie Gahler	Elsie Kreager	Sophia Martikan	Karson Risch	Cora Wright
				Hayden Wright

2025 Jr. Fair Advisory Committee

Position	Name
Jr. Fair Coordinator	Molly Avers
OSU Ext. staff member pertinent per JRFC	Rhonda Mahaney
OCAS President	Zak Avers
OCAS Vice President	Sheri Kleinhans
Jr. Fair Advisor	Angie Rahm
4-H Club Advisor	Nancy Lajti
FFA Chapter Advisor	
At Large Member	Amy Risch

2025 Ottawa County Jr. Fair Department Superintendents

Department	Last Name	First Name	Phone #	Email
Beef	Buhrow	Jerry	(419) 277-0627	jbuhrow@oakharbor.oh.us
Beef	Traver	Tyler	419-345-6222	
Goats / Llama & Alpaca	Rahm	Olivia	419-707-4781	Orahm50@gmail.com
Sheep	Buhrow	Austin	419-707-2445	Austinbuhrow99@gmail.com
Swine	Rahm	Tim	(419)707-1979	Trahm50@gmail.com
Swine	Wendt	Dan	(419) 680-5251	Dwendt1@gmail.com
Small Animal	Brandt	Anna	(419) 367-0920	amrossler@aol.com
Small Animal	Wolf	Christie	419-345-3597	cwolfrealtor@gmail.com
Horse	Steinmiller	Adam		
Carcass	Kapp	Diane	(419) 276-0472	drk1214@yahoo.com
Carcass	Kapp	Jody	419-356-8372	jodykapp@gmail.com
Royalty	Soltis	Sara	419-707-2113	sarasoltis77@gmail.com
Royalty	Audiano	Bailey	419-297-0504	
Booth	Laubacher	Jason & Kayla	(419) 341-5239	
Baker's Round Up	Pipoly	Caitlyn		caitlynxjune321@gmail.com
Awards	Dusseau	Kristen		K_lenke11@yahoo.com
Showman of Showman	Jr. Fair Board Mentors			

2025 Livestock Quality Assurance

Deadline for completion of QA is May 1st.

Date for Quality Assurance are:

March 5th 6:30-7:30pm B3 at the Fairgrounds

March 23rd 5:00-6:00pm B3 at the Fairgrounds

April 12th 9:00-10:00am at the Extension Office

April 27th 5:00-6:00pm B3 at the Fairgrounds

***** Please watch the Ottawa County 4-H Page for updated dates and times. *****

2025 Ottawa County Jr. Fair Rules & Regulations

The Junior Fair Advisory Committee reserves the final and absolute right to interpret these rules and regulations to arbitrarily determine and settle all matters, questions, or differences regarding, or otherwise arising out of, connected with, or incident to the Ottawa County Jr. Fair. The Jr. Fair Advisory Committee further reserves the right to determine unforeseen matters not covered by these rules, to amend, or add to these rules. In their judgement, it may be determined, to withdraw all premium offerings, should any emergency exist, and circumstances demand it.

1. The Junior Fair is open to any youth in Agricultural Education, Family and Consumer Sciences, 4-H Clubs, Scouting, or any other Youth Organization. The age is figured as of January 1st in all cases referred to in this book, unless otherwise stated. Junior Fair Exhibitors must not have passed their 19th birthday on January 1st of the current year.
2. To be eligible to participate or exhibit in the Junior Fair shows or activities at the Ottawa County Fair, a boy or girl must be a current member in good standing in the youth organization they represent (refer to your youth organization for criteria). All entries must be a part of the exhibitor's current project. **All 4-H and FFA Online Enrollment forms must be submitted April 1st of the current year.**
3. Online Livestock Entries: All Jr. Fair Entries and Fees must be entered into the online Fair Entry System. Instructions for completion are on the fair website. The online entry system will go live on May 1st. If entries and payments are not submitted by **June 1st**, you will be charged a \$50.00 late fee per exhibitor. ***If after June 1st, you will need to fill out a paper registration form and pay the late fee. If you have not registered by June 8th, you will not be able to attend the fair.***
4. Jr. Fair wristbands will be required for admittance onto the Ottawa County Fairgrounds. Distribution of wristbands to members in Good Standing who have completed projects will be at the Jr. Fair Board Office. Miscellaneous Project members will receive their wristbands at pre-fair judging on July 7th and July 8th and at skillathons. **Wristbands MUST be picked up by Tuesday July 15th at noon. Wristbands will only be replaced with proof of a broken band or you will be charged a replacement fee.**

Jr. Fair Miscellaneous/Still Project Exhibition

1. Check-in for the miscellaneous projects & booth set-up will be Saturday, July 12 from 8 a.m. to 1 p.m. Any special circumstances will be decided on an individual basis by the Jr. Fair Advisory Committee. Refer to the specific department section for placement. Those projects arriving at times, other than those specified, will be ineligible for county awards.
2. All Junior Fair 4-H Miscellaneous exhibits will be judged on Monday, July 7, and Tuesday, July 8, 2025.
3. All FFA Shop & Crop will be judged Monday, July 14th in the morning.
4. If an exhibitor's project has been destroyed or broken and cannot be replaced, the exhibitor may replace the project with a poster about the project. This will complete their project for exhibition. Exhibitor will not be able to receive county awards but will be able to receive a ribbon based on their project evaluation (superior, outstanding, good, needs improvement), premium money and wristbands. All cats, dogs, guinea pigs, small animals, and pet rabbits MUST be with the exhibitor.

5. Each exhibitor must be present with his/her project at the time of judging with the exception of FFA Shop and Crop projects. Prior approval of absences at judging will be authorized by the adult superintendent of the project area. Upon the approval of absence, the exhibitor must arrange for advanced judging. Projects that are advanced judged will be ineligible for county awards.
6. **All exhibits will be released on Sunday, July 20th as per the fair schedule.** Anyone removing exhibits before the specified time will forfeit awards, state fair participation for this year, and may be unable to exhibit the following year in the Ottawa County Fair. If any part of a group's booth is torn down early, that club will forfeit their \$15.00, given to them for exhibiting. Exhibits should not be left after 9:00 p.m. on Sunday. The Jr. and Sr. Fair Boards are not responsible for exhibits/projects lost or damaged items before, during or after the Jr. Fair.

DO NOT THROW ANY OTHER EXHIBITOR'S PROJECTS, POSTERS OR EXHIBITS AWAY!!!

ATTENTION:

Miscellaneous Projects will be judged during pre-fair.

(Please refer to the specific sections of the Spring Newsletter for times and dates)

For those who want to attend the Ohio State Fair, this will give them plenty of time to prepare and make plans ahead of time. (Ohio State Fair July 23-August 3, 2025)

Please refer to the fair schedule for dates, times, and locations of the awards ceremony that will cover all Pre-Fair projects.

JR. FAIR BOOTH JUDGING

Monday, July 14, 2025 – 8:00 a.m.

Booths will be set up on Saturday, July 12 from 8:00 a.m.-1:00 p.m. by members with minimal help from advisors.

Booths will be dismantled on Sunday, July 20 per fair schedule. Not any sooner! (Ottawa Co. Jr. Fair is not responsible for items left after 9:00 p.m.) Projects left will be available for pick-up at the Extension Office for 1 week after Fair ends. Projects left after this day will be disposed of.

No combustible decorating materials should be used. Fasteners such as nails, staples, thumb tacks and pushpins **must be** removed completely. Decorations should not extend above the sides and back of the booth which are 6' high and 4' deep. Each booth following the guidelines will receive a \$15.00 premium. Money will be ready for an advisor at the time of dismantles of your booth. Anyone who removes items from the booths, before the designated time, will forfeit the \$15 premium.

Project Grading Guidelines

Listed below you will find the grading system for pre-fair and miscellaneous projects. We hope this will allow more opportunities to give exhibitors extra recognition when they need encouragement and hope they would try again.

Superior (Dark Purple Ribbon): Exhibitor who went above and beyond the project requirements. They had superior knowledge of project and developed an extensive exhibit. (Skillathon score of 95-100)

Outstanding (Light Purple Ribbon): Exhibitor who met all project requirements. They had basic knowledge of subject matter and a nice exhibit. (Skillathon score of 85-94)

Good (Green Ribbon): Exhibitor who only met some project requirements. They need more project knowledge and more extensive exhibit. (Skillathon score of 71-84)

Needs Improvement (Light Green Ribbon): Exhibitor did not meet the project requirements. (Skillathon score below 70)

When selecting overall winners, the judges will start with the superior ratings then move on to outstanding members. Placings and decisions are the judge's discretion. Projects that are advanced judged will be ineligible for county awards.

PREMIUM PRICES

Grade	Superior	Outstanding & Good	Needs Improvement
Department 1 Beef:			
Beef Project	\$7.00	\$5.00	\$3.00
Department 2 Goats:			
Goat Project	\$7.00	\$5.00	\$3.00
Department 3 Sheep:			
Sheep Project	\$7.00	\$5.00	\$3.00
Department 4 Swine:			
Swine Project	\$7.00	\$5.00	\$3.00
Department 5 Poultry:			
Poultry Project	\$7.00	\$5.00	\$3.00
Department 6 Rabbit:			
Rabbit Project	\$7.00	\$5.00	\$3.00
Department 8 Horses:			
Exhibiting	\$7.00	\$5.00	\$3.00
Department 10 Carcass:			
Completion	\$7.00	\$5.00	\$3.00
Pre-Fair Still Projects & FFA Shop & Crop:			
Project Complete & Judged	\$7.00	\$5.00	\$3.00

Animal premiums are based on skillathon scores, one per department.

Pre-Fair Still Projects and FFA Shop and Crop are based on project judging scores.

Club group projects will receive one premium for the club based on project judging score for the group.

Premiums that are not picked up by **August 26th** will be returned to the Fair Board.

Livestock Rules & Regulations

Superintendents and the Jr. Fair Advisory Committee may spot check for compliance of these mentioned rules. Junior Fair exhibitors not following rules will not be eligible to exhibit their animal(s) at the Ottawa County Fair.

1. All exhibitors must read and comply with all Jr. Fair General Rules and Regulations. All exhibitors must read and abide by the State of Ohio Livestock Exhibition Rules found in this book. Any exhibitor breaking these rules will be disqualified and may have additional punitive actions taken at the discretion of the Jr. Fair Advisory Committee. All Junior Fair Rabbits and Poultry must check in **between 2:00pm and 5:00m on Sunday, July 13, 2025**. Horses must check in between **8:00am and noon on Sunday, July 13, 2025**. All Junior Fair Beef, Goats, Sheep, and Swine livestock exhibits must be at check-in between **9:00am – 2:00 p.m. on Sunday July 13th 2025**. Swine will be weighed off the trailer. *Beef, goats, and sheep will not be weighed off the trailers. Exhibitors only need to bring their animal to the respective barn(s) between noon and 5:00pm. The animals will be weighed at the times listed on the move in graphic. Animals will only be weighed once, reweighs are not allowed.* Any special circumstances will be decided on an individual basis by the Jr. Fair Advisory Committee. Refer to the specific department section for placement. Those projects arriving at times other than those specified will be ineligible for county awards.
2. Jr. Fair Livestock Entry Fees: Fees collected from livestock projects are designated for use solely for Junior Fair activities and supporting the Junior Fair program. Judges, tagging supplies, show arena preparation, on-line project entry user fees, are some of the expenses incurred. No bedding is purchased by the Ottawa County Senior Fair Board through these funds. Any bedding purchased may be the result of donations made to the Ag Society specifically for that purpose.
3. If an exhibitor's project has been injured or has died and cannot be replaced, the exhibitor may replace the project with a poster about the project. This will complete their project for exhibition. Exhibitor will not be able to receive county awards, but will be able to receive a ribbon based on their project evaluation (superior, outstanding, good, needs improvement), premium money and wristband.

4. All Jr. Fair and Open Class projects will be released at on Sunday, July 20 at the time stated on the fair schedule. Anyone removing exhibits before the specified time will forfeit awards and state fair participation for this year. Exhibits should not be left after 9:00 p.m. on Sunday. Anyone removing projects early may be denied participation in the Ottawa County Fair the following year. Any exceptions to early release must be approved by the Senior Fair Board.
5. Each exhibitor must be present with his/her project at the time of judging. Prior approval of absences at judging will be authorized by the Jr Fair Advisory Committee. Upon the approval of absence, the exhibitor must arrange for another Ottawa County Jr. Fair exhibitor to show the exhibit. Those exhibitors without approved absences will not be considered for an award. All animals must be shown by an exhibitor, not a parent. Unqualified individuals or exhibitors absent from the Junior Fair Livestock Sale, without permission from the Livestock Sale Committee, will not have the animal sold through the auction and any add-ons will be deferred to the donor, and will only receive market price for the animal.
6. Ownership and Custody Requirements: Exhibitors must follow these rules:
 - A. Once an animal comes onto the grounds, possession cannot be transferred among exhibitors.
 - B. Market Beef & Beef Carcass must be in possession of exhibitor by the scheduled Tagging Day in December for identification with an EID Tag.
 - C. Beef Feeders and Dairy Market Feeders must be in possession of exhibitor by the scheduled Tagging Day, the second Saturday in May, for identification with an 840 EID tag.
 - D. Market Hogs/Carcass Hogs must be in possession by May 1 of the current year. Tagging the hogs will be done on tagging day in May. If you hold a Premise ID and your hogs are already tagged, you will be able to send in identifying pictures. More information will be sent with specifics.
 - E. Market Lambs/Carcass Lambs and Market Kids and non-market goats must be in possession by May 1 of the current year. The complete scrapie tag (i.e. OHxxxx-xxxx) information **MUST** be included in the online registration, that will be due first Saturday in May.
 - F. Turkeys, non-market chickens, non-market rabbits must be in possession by May 1 of the current year.
 - G. Commercial Broilers must be in possession by June 1st of the current year and Commercial Pen of Rabbits must be in possession **by the tattooing date.**
 - H. Animal(s) must be housed in Ottawa County or within ten (10) miles of the county line. The Jr. Fair Coordinator must approve any housing of animals outside the ten-mile limit each year **BEFORE** the appropriate tagging day.
7. Livestock Quality Assurance - Every member taking livestock (not horses) **must attend a county-wide quality assurance training**, unless they have previously tested out of their age bracket. The following options for completing Quality Assurance are listed below: (Which must be completed by May 1st)
 - A. Attend one of the trainings offered in Ottawa County
 - B. Attend a qualified QA training in another Ohio county (there may be a fee)
 - C. Attend a qualified QA training at an Ohio 4-H approved event (Poultry Clinic, Beef Expo, etc.)
 - D. Testing Out (Members age 15 and older may test out by taking the state quality assurance test and scoring at least 70%.)
8. Identification and Tagging Requirements: If you do not have an 840 tag for Swine or Beef, one will be provided at tagging day.

TAGGING

1. The procedure for tagging will be set forth by the Fair Veterinarian to provide the most humane and expeditious manner to tag or tattoo the animal, and these specifications will be accompanied with the tags.
2. All animals that wear an Ottawa County Tag will be addressed only by this tag at the Ottawa County Fair, Market Beef & Beef Carcass, Beef Feeders, Dairy Market Feeders, Market Swine & Swine Carcass.
3. Market Lambs/ Carcass Lambs and Market Kids must be identified with a complete USDA Scrapie Tag. Readable Tattoo on goats without ears is acceptable. Tag information will be submitted online via a Qualtrics by the May tagging date, prior to Fair Entry Deadline, *Tag information WILL be entered directly into the online entry system as well!*
4. All rabbits must be tattooed on the date set by the superintendent.
5. The department Superintendents, along with the Jr. Fair Advisory Committee, will oversee that the procedure is done correctly. All beef & dairy exhibitors must bring their animal(s) to the Ottawa County Fairgrounds for tagging. All tagging will be done on the stated day only! Any exceptions to this must be approved by the Jr Fair Advisory committee. Exhibitors not complying with this regulation will not be eligible for fair participation. As soon as a tag

is ripped out or lost the owner must notify the species department superintendent immediately. They will contact the *superintendent and the Ottawa County OSU Extension office*. The species superintendent will re-tag the animal. If possible, the previous ear tag must be turned in to the superintendent and the animal will be inspected to verify that an ear tag was previously present. Then at the discretion of the Jr. Fair Advisory Committee, the tag may be replaced, with no consequence on the animal or exhibitor's eligibility.

6. This rule applies to these projects: market beef, **beef carcass**, beef feeders, dairy beef feeders, market goats, market swine, **swine carcass**, market lambs and **lamb carcass**. Each Exhibitor within each of these projects may tag a maximum of 5 animals for that specific project at the specified tagging **(if tagging animals of the same species for market and carcass, you will need to identify which is market or carcass at the time of tagging)**. All animals tagged will be eligible to be presented for exhibition at the Ottawa County Jr. Fair, however, when bringing animals to the fair for check-in, each exhibitor may only present the maximum number of animals permitted to be shown by each specific show. Some exhibitors may be able to show 2 animals of a certain species or project, while others may only be able to show 1 – refer to the specific department rules for clarification of this number for each project you are bringing to the fair! Once an animal has been presented at the barn for check-in, it is considered a Jr. Fair entry and may not be replaced or transferred ownership. If an animal is declared ineligible for any reason upon check-in, the exhibitor may choose to remove it from the fairgrounds immediately, or house it for the duration of the fair and complete the remaining project requirements. If the exhibitor chooses to remove the animal, it is still considered an entry and may not be replaced. The Fair Veterinarian has the right to remove an animal from the fairgrounds if it is deemed ill or contagious. This is necessary for the health and safety of the animals and people at the fairgrounds.
- Rationale and Interpretation: This rule is designed for two reasons – to provide a consistent means of having replacement animals in the case of injury or illness to an exhibitor's animal, and to incorporate "selection" into the market projects. By the previous rule, if an animal tagged for Jr. Fair competition died before the fair, a replacement animal could be identified, allowing the exhibitor to exhibit at the fair, being eligible for showmanship but not for other county awards. With this rule, no animals will be tagged after the specified tagging date for any reason. If an exhibitor wishes to have a "back-up" animal to show in the case of an injury, illness, or death of another animal, the above provisions allow for this. These animals must be presented on the appropriate tagging day and therefore will be fully eligible for competition at the fair. An exhibitor is not required to present additional animals for tagging, but if they choose not to, and their animal is injured or dies, then no replacement may be identified at a later date. Families may choose to identify ONE family animal. This animal would only be used for siblings, and does not extend to extending family (cousins, aunts, uncles, etc.) This would count towards one of their 5 allowed animals.
 - "Selection" of livestock is incorporated into this rule by allowing exhibitors to bring to the fairgrounds only the number of animals they are permitted to show. For example, if a market beef exhibitor chooses to tag 5 steers, he/she may not bring all 5 to the fair and then decide after weigh-in which two will be shown. The exhibitor must make their "selection" of animals at home and may only bring what is allowed for exhibition. Once the animal has been presented at the barn, the exhibitor may not return home and bring an additional animal, even if the animal is declared ineligible for any reason.

Exhibition Requirements

1. Quality Assurance Requirements:

The Quality Assurance Rule 901-19-36 (ODA) is mandated by the Ohio Department of Agriculture and is enforced by the Ottawa County Sr. Fair Board and the ODA through (901-19-05) of the administrative code. Quality Assurance was developed to ensure all Jr. Fair Exhibitors receive accurate, consistent information concerning how an animal is to be raised, fed, cared for and exhibited. This educational training includes what is expected as an exhibitor at the Ottawa

County Jr. Fair. Quality Assurance Mission Statement: Quality Assurance guarantees safe, appealing, and wholesome qualities in exhibition and consumption.

In order to be in compliance with the ODA mandate, here are our county QA requirements and training.

- A. All Ottawa County Jr. Fair Market and Non-Market Exhibitors ages 8–18 years of age are REQUIRED on an annual basis to attend one QA training session, facilitated by the Ottawa County QA Team. A parent/legal guardian is recommended to attend with all exhibitors under the age of 18 as of January 1st of the current year.
- B. An exhibitor who has participated in an outside QA training taught by a Certified QA instructor can use that training in lieu of the county training to meet the state requirement. Verification of attendance is required to be submitted to Jr. Fair Coordination by the exhibitor
- C. Horse exhibitors are exempt from attending QA training. They are to complete and sign certification of their training in the Horse and Safety Program. Annual EquiStep training must be completed by **June 1st**. If you do not complete the annual EquiStep training, you will not be eligible to exhibit at the Ottawa County Fair.
- D. All QA training must be completed by **May 1st**. If you do not attend an annual Quality Assurance training, you will not be eligible to exhibit at the Ottawa County Fair.
- E. Each exhibitor must complete a Drug Use Notification online form for all animals coming to the fair. (excluding horses) Directions will be distributed at Skill-a-thon days.
- F. Quality Assurance Training Dates for this year are listed on page 3 of this handbook and watch for dates in 4-H Newsletters & on the Ottawa County 4-H Facebook page.
- G. It is the Jr. Fair Exhibitor's responsibility to attend the training date above. If you have any questions or concerns contact Jr. Fair Coordination, in writing and mail to 240 W. Lake Street, Unit C, Oak Harbor, OH 43449.

2. Livestock Interview/Skill-a-thon Judging Guidelines:

- A. All animals exhibited at the fair require Interview Judging/Skill-a-thons to be held Friday, July 11, 2025 6:00 p.m. - 8:00 p.m. (Horses only) and Saturday, July 12, 2025, 8 a.m. – 12 noon. Advanced pre-fair judging will be held June 26 and July 1, 2025 and requires approval and pre-registration. Advanced judging will be held at the Agriculture Complex, 240 Lake St., Unit C, Oak Harbor.
- B. If a youth has tested out of skill-a-thon for an age division, their completed project book MUST be brought to and turned in on skill-a-thon day.
- C. Any member taking animal projects who does not participate in Interview Judging, Quality Assurance Training and a Skill-a-thon will be ineligible to show at the fair.
- D. Interview/Skill-a-thon judging will be conducted for each species. Four stations will be set up, with three stations having hands-on activities and the fourth station conducted as an interview with a judge.
 - 1) Age categories will be set
 - a) Beginner 8-10 years old
 - b) Intermediate 11-13 years old
 - c) Senior 14-18 years old
 - 2) All questions will come from the project & resource books
- E. Bring books and feed records to judging completed up to the day of judging (judged on completeness with the understanding that they cannot be completed until after the animal is sold). Grading System:
 - 1) Interview and Skill-a-thon will be the accepted evaluation to determine premium.
 - 2) Interview grade will not affect placement in animal class.
- F. Interview Awards:
 - 1) Ribbons will be given out at species shows during the fair for exhibitors receiving a score of 90% or higher on their skillathon.

3. Medication:

- A. All market livestock, excluding Beef and Dairy Market Feeders, must have completed the online drug withdraw period upon ENTRANCE day of the Ottawa County Jr. Fair.
- B. Medication may only be given by the Ottawa County Fair Veterinarian licensed by the State of Ohio and under the direction/control of the Fair Veterinarian while on the fairgrounds and during the Ottawa County Fair, without deviation or exception. These medical records will be maintained by the Ottawa County Fair Veterinarian and be available at the request of the Sr. Fair Board.

4. Livestock Showmanship Rules & Eligibility:

- A. Showmanship is not required, but encouraged.
 - a. Everyone will be defaulted into their age group for showmanship. IF you DO NOT want to participate in showmanship, please indicate on the showmanship paper hanging in the species barn. The sheet will be available the Friday before check in- until the conclusion of check-in.
 - b. If you remove yourself, you will not be added back in the day of the show.
- B. Animals cannot be brought as a fair entry just for showmanship class
- C. Class breakdowns will be according to a random draw stated in the show order.
- D. Animals used in showmanship must be the one entered and shown by the exhibitor in a respective class in the Junior Fair. In the event of death or injury to exhibitor animal, permission may be granted by barn superintendent for using another exhibitor's animal.

Tampering and/or Misrepresentation

- 1. Tampering and/or misrepresentation as breed, age, ownership, custody, and any other irregularity in showing will be considered fraud and deception. Any premiums, trophies, awards, or sale money by such exhibitor will be withheld.
- 2. To maintain a high degree of confidence and integrity in the livestock shows, the Sr. Fair Board and Jr. Fair Coordination reserve the right to disqualify any animal fitted in an unethical manner and disqualify the exhibitor and the exhibitor's assistant who fitted the animal involved.
 - A. A Jr. Livestock show exhibitor shall be responsible for the continuous care, grooming, and preparation of the livestock entered in the Jr. Livestock show.
 - B. An exhibitor may receive assistance in the care, grooming, and preparation of the livestock entered in the Jr. Fair Livestock show. Grooming and preparation shall be limited to explanation or demonstration and the youth is actively engaged in the learning process provided by the following:
 - I. Immediate family members defined to be father, mother, sister, brother, grandfather, grandmother, uncle or aunt, step-parent or guardian.
 - II. Advisors of 4-H, FFA, or Jr. Fair in Ottawa County.
 - III. Ottawa County Jr. Fair Superintendent in that species department
 - IV. Veterinarians
 - V. Only exhibitors of the Ottawa Co. 4-H program or Ottawa Co. FFA Chapters.
 - VI. Only ONE of the above people will be allowed in the holding area during show with the exhibitor.
 - VII. Any exhibitor not following this requirement will be disqualified from showing market or non-market animals of that species at the Ottawa County Fair for the current showing year and will be ineligible to sell any market animals.

3. Refer to ODA Rule 901-19-38 concerning castration.
4. Shall fraud or deception, and proof of, as determined by the Sr. Fair Board, be discovered after the animal or animals have been shown and prior to the sale, such animal (s) shall not be permitted to sell. Then animals placing next in line at the show shall move up.
5. Should a violation be discovered after the sale, all sale money shall be returned to the buyer and the animal, carcass or carcass value shall be returned to the exhibitor. All placings in show will stand. No animals will move up. Any carcass suspected of being tampered with or suspected of containing drugs will be detained until the investigation is complete.
6. If the carcass is condemned for tampering and/or misrepresentation at the packing plant, it shall be grounds for disqualification in the on-foot and carcass division of the show. Additionally, all premiums and sale money shall be forfeited, and the loss of the animal be incurred by the exhibitor.

2025 OTTAWA COUNTY FAIR HEALTH REGULATIONS

Note: These rules are based on the ODA rules, so any changes in the 2025 ODA rules may constitute changes in these rules.

- A. Ottawa County Fair Health Regulations: Listed on the following pages are the 2024 Health Regulations. Due to possible changes by the State of Ohio, regarding health regulations and certification-please watch newsletters for changes.
1. Must be inspected by the Check-in Veterinarian for contagious and infectious diseases.
 2. Any animal showing symptoms of disease will be refused entry or taken from exhibit area.
 3. Poultry and Fowl:
 - i. Each poultry exhibitor must comply with and provide verification of one of the following (does not include waterfowl and doves):
 - ii. Poultry exhibited are obtained from a flock or hatchery of origin which is a participant in the National Poultry Improvement Plans for the eradication of disease (all commercial Ohio hatcheries meet this requirement).
 - iii. Poultry are from a flock, which has had a negative test for Pullorum disease within 12 months.
 - iv. Poultry have had a negative test for Pullorum disease within 90 days.
 4. Cattle and Feeders:
 - i. All feeder calves are to be vaccinated for Bovine Respiratory Disease Complex by Tagging Day.
 - ii. Recommended date by which to have feeder calves castrated is June 1. Any feeder calf showing evidence of testicular tissue at the fair will be ineligible for county awards.
 - iii. It is recommended that market Beef (including Beef Carcass) and feeders be dehorned by Tagging Day and required to be by exhibition.
 5. Goats and Sheep:
 - i. All goats must be de-horned.
 6. Swine:
 - i. Pseudo Rabies testing IS NOT required for the 2025 Ottawa County Jr. Fair.
2. All livestock exhibitors are expected to take care of their animals and keep exhibit area in presentable conditions at all times during the fair.
 3. If pens are not kept clean the Barn Superintendent will issue the following:
 - A. One verbal notice will be given
 - B. A written notice will be given requiring the signature of a parent/legal Guardian.
 - C. Then a \$25.00 fee will be assessed.
 - D. The fee can be assessed multiple times throughout the fair and does NOT reset daily.
 4. Manure Disposal: Each Junior Fair exhibitor who houses animals on the fairgrounds is responsible for his/her pen(s) used. The manure must be removed from the pen(s) and hauled to a designated area. The bedding for sheep and goats must be wood shavings.

2024 SEASON OHIO'S LIVESTOCK TAMPERING EXHIBITION RULES

Ohio Department of Agriculture 8995 East Main Street
Phone: 614.728.-6200

Reynoldsburg, Ohio 43068
ODA URL: www.agri.ohio.gov

Email: agri@mail.agri.state.oh.us

Chapter 901-19 Livestock Exhibitions

901-19-01 Definitions.

As used in Chapter 901-19 of the Administrative Code:

- (A) "Accessory reproductive tissue" includes testicular tissue and epididymis.
- (B) "Agricultural society" or "society" means a county agricultural society or an independent agricultural society that is organized under the laws of the state of Ohio.
- (C) "Approved drug" means a drug with an established tolerance approved by the United States food and drug administration listed at 21 C.F.R. part 556 when used according to label directions for the species indicated on the label.
- (D) "Breed show" or "breed class" means a show or class limited to breeding stock of a specific breed of livestock.
- (E) "Class" means a division within a show or exhibition as defined by a sponsor.
- (F) "Department" means the department of agriculture created under section [121.02](#) of the Revised Code.
- (G) "Designee" when used in reference to an exhibitor, means a member of the exhibitor's family or household or any other registered or authorized representative of the exhibitor.
- (H) "Director" means the Ohio director of agriculture appointed pursuant to section [121.03](#) of the Revised Code.
- (I) "Drenching" means the act of using an instrument, including a bottle, placed in an animal's mouth to orally administer a liquid, food, or any other substance.
- (J) "Drug" means drug as defined in section [4729.01](#) of the Revised Code and its metabolites.
- (K) "Drug use notification form" means the declaration statement or document completed by the exhibitor attesting to responsible drug stewardship and to the slaughter eligibility of the livestock for food safety purposes.
- (L) "Exhibition" means any of the following:
 - (1) A show or sale of livestock at a fair or elsewhere that is sponsored by or under the control of a county or independent agricultural society organized under section [1711.01](#) or [1711.02](#) of the Revised Code;
 - (2) A show or sale of livestock at the Ohio state fair;
 - (3) A livestock show at a fair or elsewhere or a livestock sale at or associated with a fair or livestock show that is assembled for any length of time;
 - (4) A livestock show at a fair or elsewhere or a livestock sale at or associated with a fair or livestock show that includes livestock with origins outside this state;
 - (5) Any show or sale of livestock at a fair or elsewhere that is specified by rule of the director of agriculture adopted under section [901.72](#) of the Revised Code.
- (M) "Exhibition drug residue legal" means livestock:
 - (1) Have only been administered an approved drug, for which the withdrawal time has elapsed and met tolerance;
 - (2) Have not been administered an unapproved drug; and
 - (3) Do not contain an unlawful substance.
- (N) "Exhibitor" means any person who shows, displays, or exhibits livestock at an exhibition.
- (O) "Extra label use" or "extra label" means the same as the definition as listed in 21 C.F.R. 530.3.
- (P) "Fair" means the annual exhibition held by the Ohio expositions commission, pursuant to division (A)(1) of section [991.03](#) of the Revised Code, or a county agricultural society or independent agricultural society, as reported to the director pursuant to rule [901-5-11](#) of the Administrative Code.
- (Q) "Family" means the immediate family of an exhibitor, including but not limited to the exhibitor's parent, step-parent, foster parent, grandparent, step-grandparent, foster grandparent, brother, sister, step-brother, step-sister, half-brother, half-sister, son, daughter, step-son, step-daughter, or guardian.
- (R) "Grand champion" means the highest placing livestock entry of a show.
- (S) "Household" means the permanent residence address of the exhibitor.
- (T) "Internal rule" means any rule adopted by a sponsor or applicable to the sponsor's exhibition, and includes all mandatory rules and those optional rules from which the sponsor does not exempt itself or its exhibition.
- (U) "Junior livestock show or junior livestock exhibition" means a show limited to exhibitors eight years of age and in the third grade through nineteen years of age, or as authorized to participate in either 4-H, FFA, or other youth organization.
- (V) "Label" means the attached label, labeling statement, or the accompanying brochure that lists the approved species, dose, route of administration, withdrawal time and any cautionary statement as permitted by the United States food and drug administration; a prescription label; or the requirements of labeling for an extra label use drug as permitted by the United States food and drug administration.
- (W) "Licensed livestock facility" means a livestock facility licensed pursuant to Chapter 943. of the Revised Code or a similar law of another state.
- (X) "Livestock" means any animal generally used for food or in the production of food, including cattle, sheep, goats, rabbits, poultry, swine, alpacas, and llamas.
- (Y) "Mandatory rule" means any rule adopted by the director relating to food safety or the health, safety, or welfare of livestock and from which a sponsor may not exempt itself or its exhibition.
- (Z) "Market flock style project" means ownership including an individual junior exhibitor, family of a junior exhibitor or a cooperative made up of junior exhibitors. Through this type of ownership, the junior exhibitor(s) are to care for, groom, and select any and all birds to be used in exhibitions as well as actively participate in any decision making processes for the flock.

- (AA) "Market livestock" means exhibition livestock bred, raised, and intended for slaughter for food purposes. For the purposes of this chapter, horses are not considered livestock.
- (BB) "Market poultry" means birds including, but not limited to, meat chickens, turkeys, geese and ducks.
- (CC) "Non-terminal show" means a show in which no livestock is required to be slaughtered.
- (DD) "Official eartag" means a United States department of agriculture animal and plant health inspection service approved electronic identification device that is both visibly and electronically readable and approved by the department.
- (EE) "Official veterinarian" means any licensed and accredited veterinarian approved by the Ohio department of agriculture, or an employee of the Ohio department of agriculture or the United States department of agriculture, animal plant health inspection service, veterinary services.
- (FF) "Optional rule" means any rule adopted by the director from which a sponsor may exempt itself or its exhibition.
- (GG) "Partial terminal show" means a show in which no fewer than the grand champion and reserve grand champion in each show or market class of livestock are sent directly to slaughter or to a licensed livestock facility no later than or immediately following the conclusion of the exhibition.
- (HH) "Prescription" means prescription as defined in division (H) of section [4729.01](#) of the Revised Code.
- (II) "Quarantine" means isolation pursuant to section [941.07](#) of the Revised Code.
- (JJ) "Reserve grand champion" means the second highest placing livestock entry of a show.
- (KK) "Residue" means residues as defined in section [941.01](#) of the Revised Code.
- (LL) "Show" means that part of the exhibition restricted to competitively exhibiting a single species or category of livestock.
- (MM) "Slick clipping" or "body shaving" means having hair that is less than one half inch in length on the body of market hogs.
- (NN) "Terminal show" means a show in which all livestock entered in the show are sent directly to slaughter or to a licensed livestock facility no later than or immediately following the conclusion of the exhibition.
- (OO) "Tolerance" means the lowest of the maximum concentrations of a marker residue, or other residue indicated for monitoring, that can legally remain in edible tissues of a treated animal species according to label instructions under United States food and drug administration regulations found in 21 C.F.R. part 556.
- (PP) "Unapproved drug" means:
- (1) Any drug, chemical, or pharmacologic compound not approved for use in livestock by the United States food and drug administration;
 - (2) A drug, or approved drug used extra label, for which no established tolerance has been listed by the United States food and drug administration under 21 C.F.R. 556, but has been detected through testing;
 - (3) Any drug, chemical, or compound that alters the mental or behavioral status of the animal, including, but not limited to sedatives, tranquilizers, depressants, stimulants, or dissociative or psychoactive compounds;
 - (4) Any drug prohibited by division (E)(1)(b) of section [901.76](#) of the Revised Code; or
 - (5) An approved drug administered to livestock not in accordance with paragraph (M) of rule [901-19-12](#) of the Administrative Code.
- (QQ) "Unlawful substance" means any of the following:
- (1) A substance which is not normally found in or does not naturally occur in livestock;
 - (2) A substance which is normally found in or does naturally occur in livestock, but is detected or discerned in an amount or area greater than normal;
 - (3) Any drug required to be listed, but which is not listed on a drug use notification form;
 - (4) Any unapproved drug present in livestock regardless of how the drug came to be present; or
 - (5) Any other drug, chemical, or compound which is not considered an approved drug.
- (RR) "Veterinarian" means any person licensed to practice veterinary medicine under Chapter 4741. of the Revised Code or under the similar laws of another state.
- (SS) "Withdrawal period" or "withdrawal time" means the period of time from when a drug is administered to when the drug concentration falls below the tolerance.

Last updated May 23, 2024 at 8:21 AM

Supplemental Information

Authorized By: [901.72](#)

Amplifies: [901.70](#)

Five Year Review Date: 5/23/2029

Prior Effective Dates: 7/6/1995 (Emer.), 10/4/1995, 6/23/1996, 5/1/1997, 6/1/1998, 5/31/2001, 2/15/2003, 2/17/2006, 3/21/2016

901-19-02 Types of shows; slaughter.

This is a mandatory rule.

- (A) The sponsor of an exhibition shall designate each of the shows held at the exhibition as one of the following types: terminal show, partial terminal show, or non-terminal show.
- (B) All livestock shall be exhibition drug residue legal prior to the start of the show in which the livestock is entered into for exhibition.
- (C) All of the following junior livestock shows or classes at a fair are terminal shows or partial terminal shows unless at least thirty days prior to the opening of the show, the sponsor has submitted a written request to exempt a show from this provision, and the director has provided written authorization granting this request prior to the start of the fair:
- (1) Market beef;
 - (2) Market hog;
 - (3) Market lamb;
 - (4) Market dairy cattle;
 - (5) Veal calf; and
 - (6) Market goat.
- (D) All livestock which participate in a terminal show shall be exhibition drug residue legal and be consigned to slaughter either at the conclusion of the show or exhibition.

(E) In a partial terminal show at least the grand champion and the reserve grand champion shall be slaughtered. Prior to the show, the sponsor of the exhibition may require that additional livestock from a partial terminal show shall be slaughtered. The livestock shall be consigned to slaughter either at the conclusion of the show or exhibition.

(F) All livestock required to be slaughtered under this rule shall be slaughtered at a meat establishment either licensed by the department or granted inspection by the United States department of agriculture.

(G) Livestock required to be slaughtered under this rule may, at the option of the sponsor of the exhibition, be consigned to a licensed livestock facility for sale provided that:

(1) The livestock is consigned either at the conclusion of the show or exhibition; and

(2) The livestock is sold only for slaughter.

(H) From the beginning of the exhibition until departure for slaughter or consignment to a licensed livestock facility, the exhibitor or the exhibitor's designee shall be responsible for caring for the livestock.

(I) Livestock destined for slaughter or consignment to a licensed livestock facility shall not be removed from the exhibition grounds until the livestock is transported to slaughter, to the licensed livestock facility, or until the sponsor approves movement of the livestock to another secure area for:

(1) Disease control in accordance with paragraph (B)(4) of rule [901:1-18-03](#) of the Administrative Code; or

(2) Quarantine for residue to allow a withdrawal time as determined by the approved fair veterinarian or in accordance with the instructions listed on the drug use notification form to elapse and may be subject to testing.

(J) All livestock destined for slaughter may be subject to testing by the director in accordance with section [901.73](#) of the Revised Code.

(K) Livestock carcasses passing inspection may be released for normal disposition.

(L) During inspection or testing, if the livestock carcass is preliminarily determined to have been tampered with or found to contain an unlawful substance, one of the following shall occur:

(1) If the livestock carcass must be trimmed or reconditioned to comply with the meat inspection requirements, the carcass shall be trimmed and reconditioned and released to the exhibitor, unless the successful bidder accepts the trimmed or reconditioned carcass.

(2) If the livestock carcass cannot be trimmed or reconditioned, it shall be condemned in accordance with the meat inspection requirements.

(M) Livestock entered in or eligible for a carcass contest prior to or during a terminal, partial terminal, or non-terminal show must be exhibition drug residue legal at the time of show and eligible for immediate slaughter.

Last updated May 23, 2024 at 8:21 AM

Supplemental Information

Authorized By: [901.72](#)

Amplifies: [901.74](#)

Five Year Review Date: 5/23/2029

Prior Effective Dates: 7/6/1995 (Emer.), 10/4/1995, 6/23/1996, 5/1/1997, 6/1/1998, 3/25/2000, 3/21/2016

901-19-03 Auction sales at terminal or partial terminal shows.

This is a mandatory rule.

(A) A sponsor may hold an auction sale of livestock exhibited at a terminal or partial terminal show.

(B) An exhibitor who exhibits livestock at a terminal show or partial terminal show consents to participating in the subsequent auction sale.

(C) All bidders at an auction sale following a terminal show or partial terminal show consent to the slaughter of the livestock or delivery to a licensed livestock facility.

(D) Title to livestock sold at an auction sale and subsequently presented for slaughter or sale at a licensed livestock facility shall remain vested in the exhibitor. If the exhibitor is not the owner, the title to the livestock shall remain vested in the owner until the livestock has been passed by inspection and released in accordance with paragraphs (L)(1) and (L)(2) of rule [901-19-02](#) of the Administrative Code and passes all testing performed by or at the direction of the department or the sponsor.

(E) At the discretion of the sponsor, the sponsor may collect the sale proceeds from the successful bidder and retain the proceeds until the carcass of the livestock has been released, or may allow the successful bidder to withhold payment of the proceeds until the carcass is released. In the event the carcass is not released, the sponsor shall return the sale proceeds to the successful bidder.

(F) Prior to the auction, the sponsor shall announce the identification of the exhibition livestock which have been administered drugs for which the withdrawal time has not elapsed.

Last updated May 23, 2024 at 8:21 AM

901-19-04 Prohibited practices.

This is a mandatory rule.

It is a prohibited practice to do any of the following:

(A) Show, sell, or offer for sale any livestock, including the sale or offering for sale in an auction at a terminal or partial terminal show, which:

(1) Has been subjected to unacceptable practices as outlined in rule [901-19-13](#) of the Administrative Code;

(2) Is not exhibition drug residue legal; or

(3) A withdrawal period for extra label use has not elapsed.

(B) Make a false statement on a drug use notification form.

(C) Fail to file or update a drug use notification form as required by rule [901-19-06](#) of the Administrative Code.

(D) Knowingly, recklessly, or negligently cause an unapproved drug or unlawful substance to be present in livestock.

(E) Fail to sign a chain of custody form.

(F) Violate a mandatory rule.

(G) Violate any optional rule from which a sponsor or exhibition did not exempt itself.

(H) Fail to render assistance as provided by section [901.73](#) of the Revised Code.

Last updated May 23, 2024 at 8:22 AM

Supplemental Information

Authorized By: [901.72](#)

Amplifies: [901.72](#), [901.73](#), [901.74](#), [901.76](#)

Five Year Review Date: 5/23/2029

Prior Effective Dates: 7/6/1995 (Emer.), 10/4/1995, 6/23/1996, 5/1/1997, 6/1/1998, 3/21/2016

901-19-05 Responsibilities of an exhibition sponsor.

This is a mandatory rule.

(A) Every sponsor of an exhibition shall appoint a person as its records official. The records official shall receive and maintain the drug use notification forms filed under rule [901-19-06](#) of the Administrative Code.

(1) The records official shall:

(a) Reject any drug use notification form that is incomplete, illegible, or unsigned. At the close of the exhibition the records official shall turn over the drug use notification forms received by the records official to the sponsor.

(b) Prior to the show, ensure the submitted drug use notification forms are in compliance with paragraph (I) of rule [901-19-06](#) and rule [901-19-07](#) of the Administrative Code.

(c) Review the submitted drug use notification forms for compliance with paragraph (K) of rule [901-19-13](#) of the Administrative Code if applicable.

(2) The sponsor shall maintain all drug use notification forms for a period of one year from the close of an exhibition. The drug use notification forms shall be made available to the department for inspection and copying upon request.

(B) Prior to the start of an exhibition, the sponsor shall establish a method of identifying each animal in a terminal, partial terminal, and non-terminal show and maintain a chain of custody for each market livestock animal from the show through consignment to either slaughter or a licensed livestock facility for sale. In addition, effective January 1, 2027, cattle and swine are to be minimally identified with an official eartag. The sponsor shall maintain a record of the identity of each animal and its chain of custody for a period of one year from the date of the last day of an exhibition.

(C) All county and independent agricultural societies and the Ohio expositions commission shall provide the uniform resource locator (URL) in the premium book for the current year to the effective version of all of the following:

(1) Chapter 901:1-18 of the Administrative Code, exhibition of animals;

(2) Chapter 901-19 of the Administrative Code, livestock exhibitions; and

(3) Sections [901.70](#) to 901.76 of the Revised Code.

The effective version of Ohio Administrative Code and Ohio Revised Code can be located on the "Ohio Laws & Administrative Rules" website, codes.ohio.gov, maintained by the Ohio legislative service commission.

(D) All other exhibitions shall provide to exhibitors, upon request, a copy of Chapters 901:1-18 and 901-19 of the Administrative Code and sections [901.70](#) to [901.76](#) of the Revised Code and include the following statement in at least one written or electronic announcement prior to the beginning of the exhibition:

"The exhibition's management will provide, upon request of an exhibitor, a copy of Chapters 901:1-18 (Ohio's livestock health exhibition rules) and 901-19 (Ohio's livestock tampering exhibition rules) of the Administrative Code and sections [901.70](#) to [901.76](#) of the Revised Code.

Last updated May 23, 2024 at 8:22 AM

Supplemental Information

Authorized By: [901.72](#)

Amplifies: [901.72](#), [901.74](#)

Five Year Review Date: 5/23/2029

Prior Effective Dates: 6/23/1996, 5/1/1997, 3/19/1999, 3/25/2000, 2/15/2003, 3/21/2016

901-19-06 Drug use notification.

This is a mandatory rule.

(A) The exhibitor and the owner of livestock are responsible for completing and filing out the drug use notification form in the manner required by this rule.

(B) The drug use notification form shall be signed by either the exhibitor or the owner. If the person signing the form is a minor child, the form shall be cosigned by a parent or guardian of the minor child.

(C) The director requires a drug use notification form to be completed for the following livestock exhibited in a junior livestock show:

(1) Market beef;

(2) Market hog;

(3) Market lamb;

(4) Veal calf;

(5) Market dairy cattle;

(6) Market goats;

(7) Market poultry;

(8) Lactating dairy animals ;

(9) Market rabbits; and

(10) Feeder cattle.

(D) Additionally, a drug use notification form shall be completed for all livestock eligible for a drug or residue test sample collected at every terminal, and partial terminal, or non-terminal show, and for every animal that is administered an approved drug either immediately before or during an exhibition.

(E) The drug use notification form shall be filed with the records official prior to the show in which livestock are entered.

(F) The director may require a drug use notification form to be completed for livestock exhibited at any type of show including a non-terminal show.

(G) If the information on the form regarding drug use changes or if a drug is subsequently administered at any time after the drug use notification form is filed, an updated drug use notification form shall immediately be filed with the records official.

(H) No person shall submit an incomplete, illegible, or unsigned drug use notification form.

(I) When a drug use notification form is missing, incomplete, illegible, or unsigned neither the exhibitor nor the owner shall, until the defect is corrected:

(1) Receive any prizes or awards from shows in which the livestock was exhibited prior to the time the drug use notification form was to be filed;

(2) Participate in any shows or sales held subsequent to the time the drug use notification form was to be filed.

Last updated May 23, 2024 at 8:22 AM

Supplemental Information

Authorized By: [901.72](#)

Amplifies: [901.72](#), [901.74](#)

Five Year Review Date: 5/23/2029

Prior Effective Dates: 7/6/1995 (Emer.), 10/4/1995, 6/23/1996, 5/1/1997, 6/1/1998, 3/19/1999, 3/25/2000, 2/15/2003, 3/21/2016

901-19-07 Quality assurance.

This is a mandatory rule.

(A) Except as stated in paragraph (B) of this rule, sponsors shall require exhibitors at fairs sponsored by county or independent agricultural societies or the Ohio exposition commission to annually attend or complete a quality assurance program sponsored and conducted cooperatively by the exhibition sponsor, Ohio state university extension, Ohio agricultural education, or agricultural commodity organizations.

(B) At the discretion of Ohio state university extension, or Ohio agricultural education, an exhibitor may pass a test based on the appropriate skill level for their age (twelve to fourteen or fifteen to eighteen) under the supervision of Ohio state university extension or Ohio agricultural education before exhibiting terminal or partial terminal market livestock, including market poultry, and lactating dairy animals in a junior livestock show. Youth who pass the test will be exempt from annual quality assurance re-certification until they move to the next age bracket or they are no longer a junior exhibitor (nineteen years of age or older on January first of their last year). Minimum standards for youth food animal quality assurance are as set forth in appendix A to this rule.

(C) Exhibitors who fail to attend or complete a quality assurance program or fail to pass the exam as outlined in paragraph (B) of this rule are subject to the disciplinary actions listed in rule [901-19-21](#) of the Administrative Code.

Last updated September 19, 2024 at 1:47 PM

Supplemental Information

Authorized By: [901.72](#)

Amplifies: [901.72](#)

Five Year Review Date: 5/23/2029

Prior Effective Dates: 5/1/1997, 3/19/1999, 3/25/2000, 2/15/2003, 2/13/2004, 2/19/2007, 2/19/2008, 3/21/2016, 3/23/2017, 4/22/2018

901-19-09 Drug residues in non-terminal show animals.

This is a mandatory rule.

(A) A person may, notwithstanding paragraph (E) of rule 901-19-04 of the Administrative Code, show at a non-terminal show an animal which has been administered a drug provided they are in compliance with all of the following:

- (1) The drug is a prescription drug or an extra label use of a drug and the drug is prescribed by a veterinarian pursuant to a valid veterinarian-client-patient relationship;
- (2) The drug is administered or used only in accordance with label directions or the prescription;
- (3) The drug is administered or used only for medical purposes; and,
- (4) A drug use notification form is completed and filed in accordance with the applicable requirements of rule 901-19-06 of the Administrative Code.

(B) Milk or other food obtained from livestock which has been administered or treated with a drug and permitted to exhibit pursuant to paragraph

(A) of this rule, shall not be used for human consumption.+

Supplemental Information

Authorized By: 901.72

Amplifies: 901.72, 901.76

Five Year Review Date: 3/16/2022

Prior Effective Dates: 6/23/1996, 6/1/1998, 3/19/1999

901-19-10 Testing requirements and test results.

This is a mandatory rule.

(A) Urine, blood, tissue, and other test samples shall be collected in accordance with the department's protocol for the collection of livestock test samples at exhibitions. Test samples may be collected before, during, or immediately after a show. Deviation from the protocol shall be noted by the official veterinarian.

(B) The director may at the director's discretion, collect any urine, blood, tissue, or other test samples from exhibition animals.

(C) The collection of samples and coordination activities are the responsibility of the official veterinarian.

Last updated May 23, 2024 at 8:23 AM

Supplemental Information

Authorized By: [901.72](#)

Amplifies: [901.73](#)

Five Year Review Date: 5/23/2029

Prior Effective Dates: 6/23/1996, 5/1/1997, 3/21/2016

901-19-11 Humane treatment of livestock.

This is a mandatory rule.

(A) A person shall treat livestock in a humane manner and in accordance with acceptable commercial practices so as to protect the health, safety, and welfare of the livestock.

(B) All exhibitors shall comply with and abide by the policy statement and "code of practices" of the Ohio livestock coalition.

Supplemental Information

Authorized By: 901.72

Amplifies: 901.72, 901.74, 901.76

Five Year Review Date: 3/16/2022

Prior Effective Dates: 7/6/1995 (Emer.), 10/4/1995, 6/1/1998

901-19-12 Acceptable practices.

This is a mandatory rule.

The following practices are acceptable practices for the purposes of this chapter:

(A) Treating livestock:

(1) Humane;

(2) In accordance with acceptable commercial practices to protect the health, safety, and welfare of livestock; and

(3) In accordance with the Ohio livestock care standards located in division 901:12 of the Administrative Code.

(B) Adding caffeine free soda pop, gelatin, or other sweeteners to drinking water in nominal amounts to encourage water consumption;

(C) Hoof trimming;

(D) In preparation and prior to exhibition in accordance with sponsor and best management practices:

(1) Cosmetic dehorning in market class livestock;

(2) Castration;

(3) Beak trimming;

(4) Dehorning;

(5) Hot or freeze branding;

(6) Humane ringing; and

(7) Tail docking in accordance with division 901:12 of the Administrative Code;

(E) Using collodion as a teat sealant, but for no longer than eighteen hours;

(F) Adding molasses or other sweeteners to feed to encourage consumption;

(G) Properly administered and approved growth implants;

(H) Tattooing;

(I) Ear notching;

(J) Ear tagging;

(K) Shearing;

(L) Acceptable surgery, including clamps, bands, and chemical castration;

(M) Treatment and administration of livestock with approved drugs during an exhibition under the following conditions:

(1) By or under the supervision and direction of an official veterinarian;

(2) In conjunction with a valid veterinarian-client-patient relationship;

(3) Only in accordance with label directions;

(4) For a valid medical purpose;

(5) A drug use notification form is completed and filed in accordance with the applicable requirements of rule [901-19-06](#) of the Administrative Code;

(6) The livestock remain exhibition drug residue legal at the time of the show; and

(7) If applicable, an extended withdrawal time is assigned to the drug by the veterinarian as part of the extra label directions and reported on the drug use notification form.

(N) Application of ice, ice packs, cold packs, or cold compresses prescribed to relieve heat stress or a medical condition diagnosed and prescribed by the official veterinarian at an exhibition.

Last updated May 23, 2024 at 8:23 AM

Supplemental Information

Authorized By: [901.72](#)

Amplifies: [901.72](#), [901.76](#)

Five Year Review Date: 5/23/2029

Prior Effective Dates: 7/6/1995 (Emer.), 10/4/1995, 6/23/1996, 5/1/1997, 6/1/1998, 3/25/2000, 5/31/2001, 3/21/2016

901-19-13 Unacceptable practices.

This is a mandatory rule.

The following practices are unacceptable and prohibited:

(A) Applying any electrical, mechanical, or other appliance to livestock repeatedly or for a prolonged time period in violation of 9 C.F.R. 313.2 (1979) or division 901:12 of the Administrative Code.

- (B) Hitting, striking, beating, or otherwise impacting livestock that induces swelling or enhances, transforms or changes the natural conformation, configuration, performance, physiological state, or appearance of the livestock.
- (C) Applying any physical practice, electrical or mechanical appliance, device, or apparatus that enhances, transforms, or changes the natural conformation, configuration, performance, physiological state, or appearance of the livestock, unless prescribed by the official veterinarian for the immediate treatment and welfare of the livestock. If such treatment is applied during the exhibition, the livestock are ineligible to be shown.
- (D) Plugging of teats.
- (E) Sealing of teats using unapproved substances or for longer than eighteen hours using approved substances.
- (F) Injecting material into udders or teats for non-medical purposes or otherwise artificially modifying the appearance or conformation of the udder or teat.
- (G) Using ice, ice packs, cold packs, or cold compresses internally or externally other than in accordance with paragraph (N) of rule [901-19-12](#) of the Administrative Code during an exhibition.
- (H) Using a stomach tube or pump for any purpose other than for the relief of tympany or gas during an exhibition.
- (I) Drenching of livestock at an exhibition is prohibited, unless prescribed by the official veterinarian.
- (J) Castration of livestock for the purposes of this rule which exceed the following criteria:
- (1) Cattle over eight months of age;
 - (2) Swine over one hundred fifty pounds;
 - (3) Sheep over seventy-five pounds; or
 - (4) Goats over fifty pounds.
- (K) Showing livestock which have been treated with an approved drug when a side effect or pharmacological effect of the drug conceals, enhances, transforms, or changes the natural conformation, physiological status, or condition of the livestock.
- (L) Any natural occurrence or surgical process which results in testicular tissue remaining in the body of exhibition livestock, except for rabbits and poultry.

Last updated May 23, 2024 at 8:24 AM

Supplemental Information

Authorized By: [901.72](#)

Amplifies: [901.72](#), [901.74](#)

Five Year Review Date: 5/23/2029

Prior Effective Dates: 7/6/1995 (Emer.), 10/4/1995, 6/23/1996, 5/1/1997, 6/1/1998, 5/31/2001, 3/21/2016

901-19-19 Absolute liability.

This is a mandatory rule.

- (A) Both the exhibitor and the owner of livestock are absolutely liable to discipline under rule [901-19-21](#) of the Administrative Code for the presence of an unapproved drug, residue, an unlawful substance, or an approved drug that exceeds tolerance in livestock and unacceptable practices.
- (B) If the exhibitor or the owner was a minor child at the time the unapproved drug, residue, unlawful substance, approved drug exceeding tolerance, or unacceptable practice was detected, the parent or guardian of the person shall also be absolutely liable to discipline under rule [901-19-21](#) of the Administrative Code.
- (C) The director or the sponsor when imposing discipline under paragraph (A) of this rule upon a person, may mitigate the discipline imposed based upon one or more of the following facts if established.
- (1) The person did not introduce the unapproved drug, residue, or unlawful substance into the livestock or do any unacceptable practices;
 - (2) The person had no actual or constructive knowledge that the unapproved drug, residue, unlawful substance, or approved drug exceeding tolerance was introduced into the livestock or that unacceptable practices were detected;
 - (3) The unapproved drug, residue, unlawful substance, or approved drug exceeding tolerance was not introduced into the livestock and the unacceptable practices were not detected through the person's negligence.

Last updated May 23, 2024 at 8:24 AM

Supplemental Information

Authorized By: [901.72](#)

Amplifies: [901.72](#)

Five Year Review Date: 5/23/2029

Prior Effective Dates: 7/6/1995 (Emer.), 10/4/1995, 6/23/1996, 6/1/1998, 3/21/2016

901-19-21 Disciplinary action.

This is a mandatory rule.

- (A) Any person who violates a provision of sections [901.70](#) to [901.76](#) of the Revised Code or any provision of this chapter is subject to any of the following disciplinary actions:
- (1) Disqualification from any exhibition;
 - (2) Disqualification of the exhibition livestock from any exhibition;
 - (3) Continuing education;
 - (4) Written letter of reprimand;
 - (5) Forfeiture or return of awards, prizes, premiums, or proceeds; or
 - (6) Pre-exhibition drug testing.
- (B) Disqualification may include any or all shows and classes and may be for any number of years.

(C) Failure to comply with the rules of this chapter may result in the department taking action pursuant to section [941.07](#) of the Revised Code, issuing a quarantine order, or issuing a notice of violation until such time that the violation has been remedied.

Last updated May 23, 2024 at 8:24 AM

Supplemental Information

Authorized By: [901.72](#)

Amplifies: [901.74](#)

Five Year Review Date: 5/23/2029

Prior Effective Dates: 6/23/1996, 6/1/1998, 3/25/2000, 3/21/2016

901-19-31 Responsibilities of and assistance to junior fair exhibitors.

This is an optional rule.

(A) A junior livestock show exhibitor shall be responsible for the continuous care, grooming, and preparation of the livestock entered in the junior livestock show.

(B) An exhibitor may receive assistance in the care, grooming, and preparation of the livestock entered in the junior livestock show, provided that the assistance shall be limited to explanation or demonstration provided by the following:

- (1) Family members;
- (2) Household members;
- (3) Advisors or adult volunteers of 4-H or FFA in the exhibitor's club or county;
- (4) Agricultural education instructors;
- (5) County extension agents;
- (6) Department representatives;
- (7) Veterinarians;
- (8) Members of the exhibitor's 4-H club, FFA chapter, or other youth organizations; and
- (9) Guest speakers of the 4-H, FFA, or other youth organizations.

(C) Any person not specified in paragraph (B) of this rule who provides assistance to a junior livestock show exhibitor shall register in writing with the sponsor. The responsibility to register rests with the exhibitor. An assistant may register for more than one exhibitor. Failure to register constitutes grounds for disciplinary action against the exhibitor. Assistance shall be limited to explanation and minimal demonstration.

Last updated May 23, 2024 at 8:24 AM

Supplemental Information

Authorized By: [901.72](#)

Amplifies: [901.72](#)

Five Year Review Date: 5/23/2029

Prior Effective Dates: 10/30/1996, 3/19/1999, 3/21/2016

901-19-32 Breed shows or classes.

This is an optional rule.

Unless otherwise modified by this chapter, the rules of the breed association shall be accepted grooming practices for that particular breed's show or class.

Last updated May 23, 2024 at 8:24 AM

Supplemental Information

Authorized By: [901.72](#)

Amplifies: [901.72](#)

Five Year Review Date: 5/23/2029

Prior Effective Dates: 10/30/1996, 3/21/2016

901-19-33 Prohibited grooming practices.

This is a mandatory rule.

The following grooming practices are prohibited in junior market livestock shows unless those grooming practices are permitted under rule [901-19-32](#) of the Administrative Code:

- (A) Using any substance to enhance or change the color of the livestock, including the livestock's hide or hooves;
- (B) Adding any substance externally to build up, change or alter the shape or conformation of the livestock, including by way of example but not limited to rope, false hair, graphite, hemp, and powders;
- (C) Pigmented grooming aides or materials; and
- (D) Slick clipping or body shaving of market hogs except on the ears and tails.

Last updated April 15, 2024 at 1:16 PM

Supplemental Information

Authorized By: [901.72](#)

Amplifies: [901.72](#)

Five Year Review Date: 3/8/2029

Prior Effective Dates: 10/30/1996, 3/25/2000, 5/31/2001, 2/15/2003

901-19-34 Outstanding market project competition.

This is an optional rule.

An exhibition may provide for an outstanding market project competition in one or more classes. The competition may include an evaluation of the livestock, demonstration of the exhibitor's showmanship abilities, or a skillathon or interview judging. The skillathon or interview judging may

include demonstration of the exhibitor's knowledge of quality assurance principles, as set forth in an industry publication or in a publication such as the "caring for animals" handout or by viewing the "caring for animals video" available from a county extension office.

Supplemental Information

Authorized By: 901.72

Amplifies: 901.72

Five Year Review Date: 3/16/2022

Prior Effective Dates: 10/30/1996, 5/1/1997

901-19-35 Recognition of disciplinary actions.

This is an optional rule.

(A) Disciplinary action by a sponsor against a person for a violation of sections [901.70](#) to [901.76](#) of the Revised Code or Chapter 901-19 of the Administrative Code shall be given full faith and credit and shall be honored at all exhibitions.

(B) A person who has been convicted of violating sections [901.70](#) to [901.76](#) of the Revised Code shall be prohibited from participating in any exhibition for a minimum period of three years.

Last updated May 23, 2024 at 8:25 AM

Supplemental Information

Authorized By: [901.72](#)

Amplifies: [901.74](#)

Five Year Review Date: 5/23/2029

Prior Effective Dates: 10/30/1996, 3/21/2016

901-19-38 False, deceptive or unacceptable practices.

This is an mandatory rule.

The following are unacceptable practices:

(A) Castration of livestock for purposes of this rule which exceed the following criteria:

- (1) Cattle over eight months of age;
- (2) Swine over seventy-five pounds; or
- (3) Sheep over seventy-five pounds.

(B) Showing any market livestock which has been treated in accordance with paragraph (A), (B) or (C) of rule 901-19-04 of the Administrative Code when a side effect of the drug conceals, enhances, transforms, or changes the true conformation or condition of the livestock.

(C) Any natural occurrence or surgical process which results in testicular tissue remaining in the body of exhibition livestock except rabbits and poultry.

Supplemental Information

Authorized By: 901.72

Amplifies: 901.72

Five Year Review Date: 3/16/2022

Prior Effective Dates: 6/1/1998, 2/13/2004

901-19-39 Ownership requirements.

(A) No exhibitor shall register, enter, or exhibit in a junior livestock exhibition any of the livestock listed in paragraphs (A)(1) to (A)(7) of this rule unless the household, as defined in rule [901-19-01](#) of the Administrative Code, at which the exhibitor is registered at has owned the livestock for not less than the length of time listed:

- (1) Market beef - one hundred fifty days;
- (2) Market dairy cattle - one hundred fifty days;
- (3) Market hogs - sixty days;
- (4) Market lambs - sixty days;
- (5) Market goats - sixty days;
- (6) Veal calves - sixty days; and
- (7) Market poultry - within five days of hatch including all individual participants in a cooperative.

(B) No exhibitor shall register, enter, or exhibit livestock in a junior breeding livestock exhibition unless the household, as defined in rule [901-19-01](#) of the Administrative Code, at which the exhibitor is registered:

- (1) Has owned the livestock for at least sixty days;
- (2) Has had the livestock registered under the exhibitor's name for at least sixty days; or
- (3) Has leased the livestock under the exhibitor's name for at least sixty days.

(C) For any exhibition other than those listed in paragraphs (A)(1) to (A)(7) and paragraph (B) of this rule, the length of time a person shall own livestock before the person may register, enter, or exhibit the livestock at an exhibition may be set by either the sponsor of the exhibition or a breed association.

(D) For the purposes of this rule, no exhibitor will be considered to own livestock if the livestock has been:

- (1) Leased to an individual after the applicable possession date; or
- (2) Exhibited in an exhibition outside of a junior livestock exhibition by an individual other than an immediate family member after the applicable possession date.

Last updated May 23, 2024 at 8:25 AM

Supplemental Information

Authorized By: [901.72](#)

Amplifies: [901.74](#)

Five Year Review Date: 5/23/2029

Prior Effective Dates: 10/30/1996, 5/15/1998, 5/31/2001, 2/17/2006, 3/21/2016, 3/23/2017

901-19-40 Meetings of the advisory committee on livestock exhibitions.

(A) Board meetings

A regular meeting of the committee shall be held at least once annually after the fifteenth day of October and before the first day of December. The committee may meet at other times as the chairperson or a majority of the committee members considers appropriate, provided the chairperson gives members notice of any meeting at least seven days prior to the meeting.

(B) Notice of meetings

(1) Regular meetings: Notice of all of the advisory board's regularly scheduled meetings, including date, starting time, and place shall be sent to the committee members by either regular or electronic mail at least seven days prior to the meeting and will be posted on the department's web site www.agri.ohio.gov at least ten days in advance of all regularly scheduled meeting.

(2) Special meetings: Notice of date, time, place, and purpose of any special meetings shall be placed on the department's website www.agri.ohio.gov and sent to media outlets that requested such information, at least twenty-four hours prior to said meeting.

(3) Emergency meetings: Notice of date, time, place, and purpose of all emergency meeting shall be given to all news media who requested prior notification and on the department's website www.agri.ohio.gov.

(C) Any person may obtain prior notice of the date, time, and location of any regularly scheduled, special, or emergency meetings by requesting prior notification in writing from the "Ohio Department of Agriculture, Office of Animal Health, 8995 East Main Street, Reynoldsburg, Ohio 43068"; or by calling the animal health division at (614) 728-6220.

Last updated May 23, 2024 at 8:25 AM

Supplemental Information

Authorized By: [901.72](#)

Amplifies: [901.72](#), [901.73](#), [901.74](#), [901.76](#)

Five Year Review Date: 5/23/2029

Prior Effective Dates: 8/25/2003, 12/14/2009, 12/1/2011, 3/21/2016

Tampering Exhibition Rules Ohio Department of Agriculture
Division of Animal Industry 8995 E. Main Street Reynoldsburg, OH 43068
614-728-6220 FAX: 614-728-6310

JUNIOR FAIR LIVESTOCK SALE

Ottawa County Junior Fair Livestock Sale Committee

Mission Statement

The Sale Committee's mission is to conduct an industry standard livestock sale with the primary goal of obtaining the best price for the Exhibitors through attraction of Buyers from all over Ottawa County.

Vision Statement

To educate exhibitors on industry standards expected of sale in coordination with the livestock superintendents and inform the buyers of the Junior Fair Livestock Sale process through advertising and promotion. The Committee will answer directly to the Senior Fair Board.

2025 Committee Members

Chairperson: AMY RISCH

Vice Chairperson: Vacant

Secretary: JULIE SPRAGUE

Treasurer: DEB MEEK

Sale Clerk: NICOLE ROLLINS

Public Relations: Vacant

Senior Fair Board Representative: AMY RISCH

The 2025 Ottawa County Jr. Fair Livestock Sale will be held on Friday, July 18th at 9:00 a.m.

Sale Order will be:

Market Lambs, Goats, Rabbits and Turkeys, Broilers, Meat Ducks, Market Beef, Beef Feeders, Dairy Beef Feeders, Market Hogs.

SALE OF CHAMPIONS at 11:00 am

All Champions and Reserve Champions animals will sell at this point of the sale.

Champion Sale order will be:
Market Lamb and Carcass, Goat, Goat Milk, Rabbit, Turkeys, Broiler, Dozen Eggs, Meat Duck, Market Beef and Carcass, Beef Feeder, Dairy Beef Feeders, Market Hog and Carcass.

The 2025 Ottawa County Jr. Fair Back to the Farm Calf Sale will be held on Saturday, July 19th at 10:00 a.m.

Buyers will be allowed to remove these calves within 1 hour after the completion of the sale or wait until the posted Sunday release time.

Questions, comments, concerns, or to help with the Livestock Sales may be directed to any member on the committee. Email communications can be sent to oclivestocksale@gmail.com.

I. Exhibitor Policy

- A. All market livestock (sheep, goats, swine, dairy and beef feeders, market beef, rabbits, broilers, meat ducks, and turkeys) will be sold at the partial-terminal sale at the Ottawa County Junior Fair Livestock Sale.
- B. The only exception is for those animals entered in State Fair competition.
 1. In which case, the exhibitor **MUST** provide a copy of the State Fair entry form to their department superintendent identifying the specific exhibitor and the animal shown at the Ottawa County fair.
 2. Using the form at the back of this book, a written request of intent to attend the Ohio State Fair **MUST** be submitted to the barn superintendent within two hours after the conclusion of their specie's show.
 3. If an animal is withdrawn from the county fair and does not show at state fair, the exhibitor must provide a written statement to the sale committee chairman within one week of the conclusion of the state fair. In this letter the exhibitor must explain why that animal did not show, or they will not be eligible for county awards the following year *and* must sell all animals in that project at the county fair the next year. Eligibility at the Ottawa County fair will be restored only if the sale committee approves the extenuating circumstances outlined in the written statement received, and the exhibitor provides a proof of slaughter of the animal in question.
 4. All Grand and Reserve Champion animals must be sold at the fair.
- C. Exhibitors of dairy and beef feeder calves shall be given the option of selling their calf at both the premium sale and the back to the farm sale, or not entering either sale and taking their calf home.
 1. All calves will be entered into the sale order unless the beef superintendent receives a written request, using the form at the back of this book, for removal from the sale, signed by the exhibitor and parent, within two hours of the conclusion of the beef show.
 2. If written notice is not given to remove the calf from the sales, and the exhibitor does not present the calf for sale, the exhibitor will not be eligible for county awards and must sell that species the following year at the fair.
 3. If the exhibitor sells at the premium sale on Friday and does not present the animal for sale at the back to the farm sale on Saturday, the premium money received will be forfeited and returned to the premium buyer. The exhibitor will not be eligible for county awards and must sell that species the following year at the fair.
 4. Champion and Reserve Champion of both feeder projects must sell at both sales for both bids, regardless of original intentions.
- D. The exhibitor of livestock is responsible for the complete care of their livestock until the indicated livestock release time directed by the Sr. Fairboard.
- E. Each exhibitor must be present with his/her project at the time of selling.
 1. Written prior approval of absences **must be presented by exhibitor in person at a livestock sale committee meeting.** (extenuating circumstances only) at the sale will be authorized by the Livestock Sale Committee.
 2. Written request **MUST** be submitted by Monday, **July 2nd, 2025**
 3. Upon the approval of absence, the exhibitor must arrange for another exhibitor to sell his/her exhibit. **Substitute's name must be submitted within the request.**
 4. All animals must be sold by an exhibitor, not a parent.
 5. **If an exhibitor's animal is disqualified, they will not be permitted to sell that species at either sale, or eligible for add-ons.**
 6. Unqualified individuals or exhibitors absent from the Junior Fair Livestock Sale, without permission from the Livestock Sale Committee, will not have the animal sold through the auction and any add-ons will be deferred to the donor, and will only receive market price for their animal.
- F. Animals must be shown in a Market Class at the fair to be eligible to sell at the Sales and receive add-on sales.

II. Insurance Policy

- A. The market animals exhibited at the Ottawa County Junior Fair will be covered by the self-insurance policy. This self-insurance policy fund was started to provide insurance for market livestock exhibitors. This extra money will be shown on the monthly treasurer's report and will not be used as part of the regular budget.
- B. The insurance will be in effect from the time the animals pass the Vet Check until they are loaded for market and leave the grounds.
- C. If for any reason, the amount of losses exceeded the amount of this insurance policy, claims will be made on a pro-rated basis.
- D. The insurance covers only animals that are sold at the Ottawa County Junior Fair Livestock Sale.
- E. All animals that go home will not be covered under this insurance policy.
- F. Determination of claims of losses must be brought to the attention of the approved Fair Veterinarian, Sale Chairman, Superintendent of the animal area, and the Sale Committee Senior Fair Board Representative.
- G. Final decisions in claims will be made by:
 - a. Approved Fair Veterinarian
 - b. Sale Chairman
 - c. Superintendent of animal area
 - d. Sale Committee Senior Fair Board Representative
- H. All market animals that are lost at the Ottawa County Junior Fair will be appraised at the market value the day of the sale.
- I. A livestock insurance premium will be deducted from Market Beef, Dairy and Beef Feeders, Market Hogs, Market Lambs, Market Kids, Pen of Broilers, Turkeys, and Pen of Rabbits. No deduction will be made from carcass animals.
 - a. Market Beef: \$5.00
 - b. Dairy and Beef Feeders: \$3.00
 - c. Market Hogs: \$1.00
 - d. Market Lambs: \$1.00
 - e. Market Kids: \$1.00
 - f. Pen of Broilers: \$0.50
 - g. Turkeys: \$0.50
 - h. Pen of Rabbits: \$0.50
 - i. Market Ducks \$0.50

III. Sale and Buyer Policy

- A. The Junior Fair Livestock Sale will be on Friday at 9:00 AM during the fair.
 - 1. Sale order will be rotated on an annual basis and determined by the Sale Committee.
- B. The Back to the Farm Calf Sale will be held on Saturday at 10:00 AM during the fair.
 - 1. Buyers will be allowed to remove these calves within 1 hour after the completion of the Back to the Farm Sale on Saturday or wait until the posted Sunday release time.
 - 2. No other livestock animals may be removed until Sunday at the indicated livestock release time directed by the Sr. Fairboard.
- C. Only Grand and Reserve Champion carcasses are sold at the Livestock Sale and eligible for add-on sales.
- D. All animals will sell for **PREMIUM BIDS ONLY**. The amount the buyer bids is the amount the exhibitor will receive in addition to the given market price.
 - 1. If the buyer wants to keep the animal(s) they will pay the premium bid PLUS the market value shown on the sale bill and complete a destination card to indicate the animal's final destination at the completion of the fair.
 - 2. All destination cards **MUST** be filled out and returned by noon on Saturday.
 - 3. You **MUST** be the successful premium buyer to complete the destination card.
 - a) Market Beef, Market Swine, Market Goats, Market Sheep – All animals sold will go to a slaughter facility or to a buyer's farm as indicated on the destination card
 - 4. The only exception is for the Grand and Reserve Champion animals in which they will be sold twice. First for advertising premium and secondly for the purchase of the meat. Market Beef, Market Swine, Market Goats, and Market Sheep will go to the indicated slaughterhouse determined by the Sale Committee.
 - 5. You must purchase the advertising to purchase the animal.

- E. The Livestock Sale Committee will be selling LIVE Broilers, Turkeys, Meat Ducks, and Rabbits. The processing arrangements for these broilers, turkeys, ducks, and rabbits will be the responsibility of the exhibitor with the buyer by private agreement.
1. The Sale Committee is not responsible for undelivered animals.
 2. Buyers must contact the Livestock Department Superintendent and/or the Jr. Fair Coordinator for assistance with exhibitors not delivering their broilers, turkeys, or rabbits.
 3. Broilers, Turkeys, Meat Ducks, Market Geese and Rabbits purchased by the Buyers Club **MUST** bring the **processed** animal back to the fairgrounds. The animals will be collected and distributed at the discretion of the sale committee. Additional drop off times for **processed** animals will be announced later. *If you fail to return your live animals at the designated time, you will be ineligible for exhibiting a market project of that species the following year.*
- F. Any animal (beef, goat, sheep, or swine) that was purchased by Buyer's Club's winning bid will go to a processor of the Sale Committee discretion. Exhibitors will receive packer bid price for the meat of the animal. There will be no option for the family to purchase the meat back. Feeder calf destination will still be determined by the Back to the Farm Sale.
- G. On Saturday evening, all superintendents will receive load out sheets indicating the animal's final destination. Market hogs will be tattooed for slaughter identification. No market animal is allowed to leave the fairgrounds prior to the indicated livestock release time without the completed Sale Removal Form turned in.
- H. Payment is expected to be made the day of the sale:**
1. All payments need to be received by August 1st.
 2. The Livestock Sale Committee reserves the right to withhold an exhibitors check if all buyers have not paid their sale invoices by August 1st.
- I. All destination cards are due by **noon on Saturday**.
- J. All bills will be subject to a 2.0% monthly service charge. Any further action to address non-payment is the responsibility of the Sale Committee.
- K. All returned checks will be assessed a \$40.00 insufficient fund fee.

IV. Exhibitor Checks and Thank You Policy

- A. Sale checks will **NOT** be mailed.
- a. Exhibitors may pick-up their sale checks at the Senior Fair Board office on Saturday, August 23rd from 9am to 12 noon, or on Tuesday, August 26th from 6pm to 8pm.
 - b. Each exhibitor **MUST** bring a thank you note for **EACH** of their buyers in an **ADDRESSED and STAMPED** envelope, in order to pick up their check. This includes add on buyers.
 - i. If the Buyer's Club was the purchaser, the exhibitor is responsible for writing FOUR thank you notes for each animal purchased. The sale committee will provide an address label.
 - ii. The final list of buyers will be available on the fair website under the Livestock Tab.
 - c. Exhibitors not providing thank you notes on those pick-up dates, can deliver their thank you's at the September Senior Fair Board meeting and receive their check.
- B. Exhibitor sale checks will become void within 90 days of issuance if not cashed.
- a. **A reissuing charge of \$50.00 PLUS a stop payment fee of \$35.00** will be deducted from those exhibitor's checks who request a VOIDED check to be reissued.
 - b. If an exhibitor does not pick up /cash their check within 6 months from the date of issuance, the Livestock Sale Committee reserves the right to return the funds to the Buyers Club.
- C. Sale deductions to defray Livestock Sale Committee expenses will be as follows:
- a. Five percent **(5%)** of sale price of all live market animals.
 - b. Five percent **(5%)** of sale price for Champion and Reserve Champion carcasses.
 - c. Appropriate check off dollars for each species will be deducted per national and state regulations.
- D. An administration fee of 3.5% will be added to any buyer's bill that chooses to use a credit card for payment.

OUTSTANDING LIVESTOCK EXHIBITOR

Conducted by the Jr. Fair Awards Department: This award is sponsored by the 4-H Advisory Committee.

- A. Exhibitors who exhibit Beef, Sheep, Swine, Carcass, Goats, Horses, Poultry, and Rabbits are eligible to participate for this award. It is NOT a requirement to participate. This is an optional activity.
- B. **Scoring will be done with a combined score of:** Skillathon 100 • Showmanship 100 • Placing 100
Total possible score of 300 points (plus additional points for Grand or Reserve Champion).

Point determination:

Showmanship: Exhibitors ranking in the showmanship class: 1st place-100pts, 2nd place-98pts., 3rd place-96pts., 4th place-94pts., 5th place-92pts., 6th place-90pts., 7th place-88pts., 8th place-86pts., 9th place-84pts., 10th place-82pts.

Skillathon: Must have a score of 75 or higher to be eligible.

Class Placing: Exhibitor's highest ranking in the class: 1st place-100pts, 2nd place-98pts., 3rd place-96pts., 4th place-94pts., 5th place-92pts., 6th place-90pts., 7th place-88pts., 8th place-86pts., 9th place-84pts., 10th place-82pts. Grand Champion is awarded 2 additional points and Reserve Champion is awarded 1 additional point.

- C. Exhibitors can only win Overall Outstanding Exhibitor one time with each species.
- D. 8 top awards will be given, one for each category (beef, sheep, swine, goats, horses, poultry, rabbits and carcass.) Also, awards will be given to the top participant in each age group by species.
- E. Tie breaker order is as follows: 1st-Highest Skill-a-thon Score, 2nd-Highest Showmanship Score, 3rd-Highest Class Score, 4th-Highest Overall Ranking, 5th-Interview by 4-H Representative and FFA Representative.
- F. Additional Notes: No pre-registration is necessary. Participant must show a live animal at fair to qualify for the program. Different animals may be used for showmanship and classes; however, they must be registered as the exhibitors.

SHOWMAN OF SHOWMEN

Please check Fair Schedule

Guidelines:

1. The contest is open to the 2025 Sr. Showmanship Winner in each of the following livestock departments: beef, goat, sheep, swine, rabbits, poultry, horses.
 - a) Winner is defined as receiving the title of Grand Champion Sr. Showmanship.
 2. If a showmanship winner is ineligible, then an eligible participant will be selected from the order of placing of that particular showmanship contest, up to 5th place.
 3. Participants will not show in species they are representing. They will show in all other animal classes.
 4. Each winner can represent 1 species. If a participant won Grand Champion Showmanship in multiple species, they will decide which species to represent an **hour** after the last show they won. For example, the Sheep show is on Monday, Hogs on Tuesday and Beef on Wednesday. If the same individual wins sheep then Hogs, they have an hour after the conclusion of the Hog show to let the Jr. Fair Coordinator know which species they will be representing, Hogs or Sheep. If they show Cattle on Wednesday and win in Cattle, they pick between Cattle and the species they previously declared, not all three options.
 5. Winners of the Showman of Showmen contest are not eligible to participate in the contest the following year. For example, the 2023 winner is ineligible to participate in the 2024 contest but will be eligible again in 2025.
 6. The contest will be conducted with an animal, selected at random draw prior to entering the ring, for each participant.
 7. Horse portion of the contest will take place in the Horse area and all participants will compete at the same time (weather permitting)
 8. Animals used in contest will be selected by the Jr. Fair Board Superintendents in charge of that particular department.
 9. Each judge will rate the participants on a scale of 1 to 6 with one (1) being the best. The participant with the fewest total points in the six departments will be the winner.
 - a) Score sheets will be made available in the Jr. Fairboard office after the show. Please allow for cleanup and copies to be made.
 10. Those planning Showman of Showman will do their best to secure out of county judges.
- In case of a tie, tying participants will be asked pre-determined question by the Jr. Fair Coordinator.

OVERNIGHT POLICY

Junior Fair livestock exhibitors wanting to stay overnight in the barns must:

- A. Be enrolled in a livestock project in that barn.
- B. Have a parental permission slip (form located at the end of this book) completed and on file in the Jr. Fair Office and permission from the Jr. Fair Committee. You will need an overnight wristband given at the Jr. Fair Board office.
- C. Policy stipulates that one adult (over 21 yrs. old), and up to a maximum of five (5) Junior Fair exhibitors, per adult, may stay overnight in one livestock project area.

LIVESTOCK AWARDS

Ribbons: Participation ribbons will be awarded for showmanship classes as well as any other extra classes. Ribbons will be awarded as follows:

- A. 1st-5th place ribbons will be given for all livestock areas.
- B. Awards may be awarded in classes with more than one entry.
- C. Any exhibitor that is not eligible for county show awards is eligible for showmanship awards.
- D. Fees may be charged for replacement ribbons. Please display out of animal's reach.

GRIEVANCES

1. The Junior Fair Advisory Committee will govern any circumstances regarding Junior Fair activities not covered by these rules and regulations (refer to the Jr. Fair Grievance Procedure).
2. Rule Violations:
 - A. In the question of a rule violation, the following due process will be used: The Junior Fair Advisory Committee will question the exhibitor and/or parties involved. If it is felt a violation has occurred and the Junior Fair Advisory Committee can find a resolution with the parties involved, their decision will be final.
3. Jr. Fair Grievance Procedure:
 - A. The purpose of the Jr. Fair Grievance Procedure is to serve as a means to resolve any grievance arising from Jr. Fair participation whether prior to the fair or during the fair and after all alternative solutions have been exhausted.
 - B. By Jan. 1 of each year, the Sr. Fair Board will appoint the co-chairpersons of the grievance panel. Co-Chairpersons will not have a vote.
 - C. The Grievance panel will consist of at least five (5) members with no more than thirteen (13) and will always contain an odd number, from the Jr. Fair Advisory Committee, Jr. Fair Board officers, and department superintendents to act and resolve any grievance.
 - D. If a chairperson is involved the other chairperson will run the process.
 - E. Only the Exhibitor can complete and file the grievance.
 - F. A grievance is to be submitted at the Sr. Fair Board Office addressed to the grievance committee chairpersons in writing within thirty (30) days of the occurrence prior to the fair or within two (2) hours of the occurrence during the fair, in a sealed envelope.
 - G. The complaint must contain the following information:
 - 1) The complete problem including the names of all involved.
 - 2) The steps taken to solve the grievance prior to submitting the grievance.
 - 3) The action required if found in favor of the submitter.
 - 4) A fee of fifty dollars (\$50.00) in cash must accompany the grievance. If the decision is made in favor of the grievant, the fifty-dollar fee will be returned. If money is not returned, it will be placed in the Jr. Fair Department Barn Fund.
 - H. The Sr. Fairboard Co-Chairs will discuss the grievance and determine if all means have been exhausted. If a grievance hearing is necessary, they will assemble the Grievance panel. The panel will notify the Party(ies) which the grievance is against and afford them the opportunity to reply in writing within seven (7) days of the notification prior to the fair or within two (2) hours of the notification during the fair.
 - I. Should the co-chairs determine to meet and hold a hearing all parties will be notified of the time and place and will be given an opportunity to present their position at that time.
 - J. A grievance will be taken under advisement within 7 days of notification of grievance if prior to the fair or within 24 hours if during the fair.

- K. All parties will be expected to abide by the decision(s) made by the panel and their decisions will be final.
- L. The meetings will be recorded for clarification purposes only.
- M. Solutions to the grievance will be submitted to the committee in the form of a motion and vote will be by secret ballot.

ABUSE/HARASSMENT POLICY

Terms

No verbal or physical abuse or harassment of Directors, Judges, Ring Stewards, Superintendents, Volunteers, or Employees of the Ottawa County Agricultural Society will be tolerated in person or online. This rule applies to any activity or reference to an activity associated with the Ottawa County Agricultural Society or its affiliations.

Consequences

Any person found to be in violation of this rule will be escorted from the fairgrounds and premiums will be forfeited. Upon the committee's decision, said person or exhibitor may not be allowed on the premise or to exhibit at the Ottawa County Fair for a period of up to Two (2) years. On the event that this rule is violated by a Parent or Guardian of an Exhibitor, upon the committee's decision, penalties may be enforced against the Exhibitor. The Committee's decision shall be final.

Committee

The committee will consist of the following: President of the Ottawa County Ag Society (or a designee of the President), the Senior Fairboard Representative of the department involved, and 3 additional board members chosen by the President.

Ottawa County Jr. Fair Check-In Traffic Flow

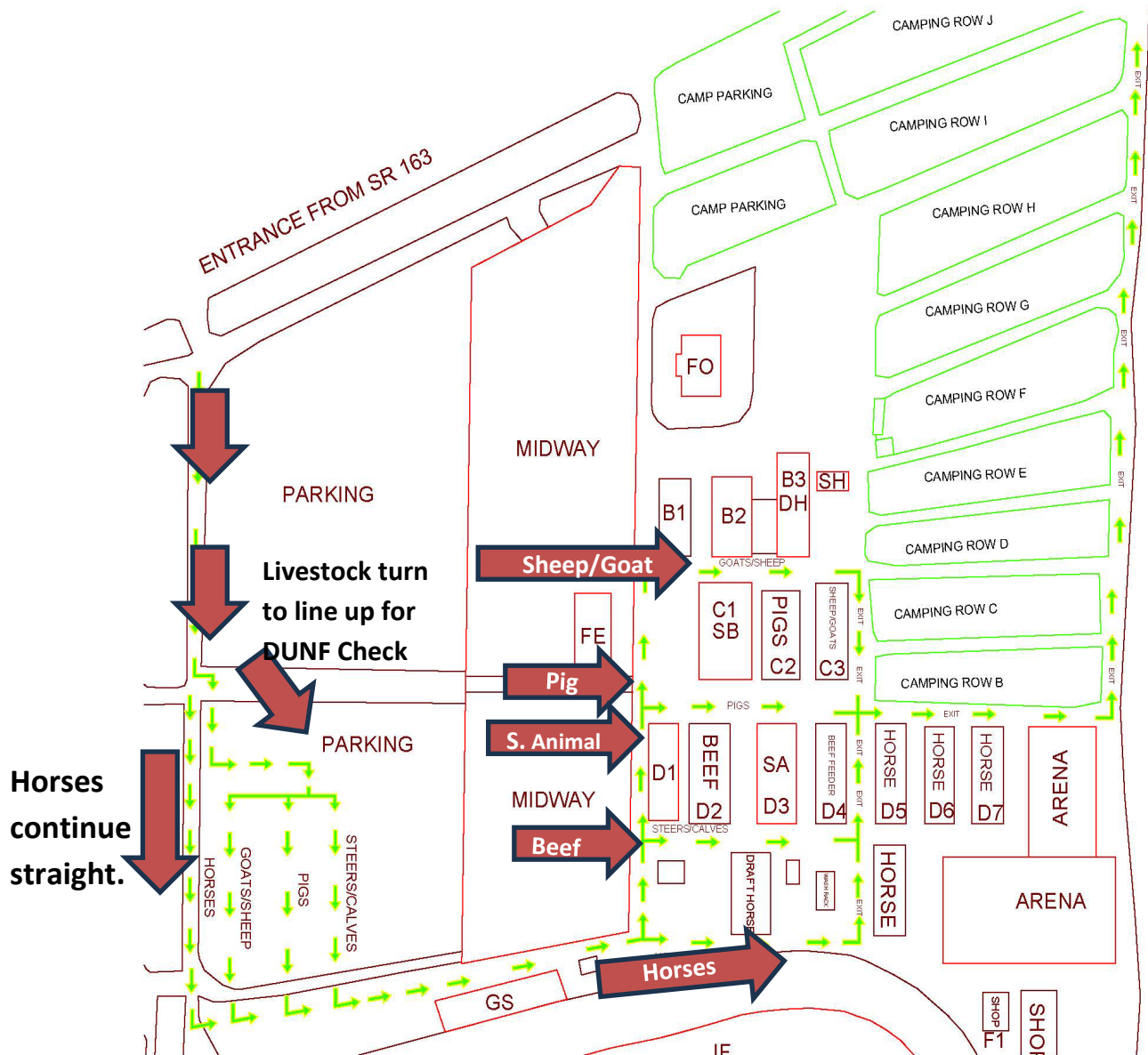

Horses Only
 Move-In Day
 July 13, 2025
 8:00 AM – noon

Small Animals
 Move-In Day
 July 13, 2025
 2:00pm-5:00pm

Livestock
 Move-In Day
 July 13, 2025
 9:00am-2:00pm

Hogs will be the only species to weigh off the trailer. Sheep will weigh at 2:30pm. Goats will weigh at 3:00pm. Beef will weigh at 6:00pm. Each animal will be weighed in once. A Friend can weigh in for you if paperwork is complete.

Ottawa County Jr. Fair Haul-Out Traffic Flow

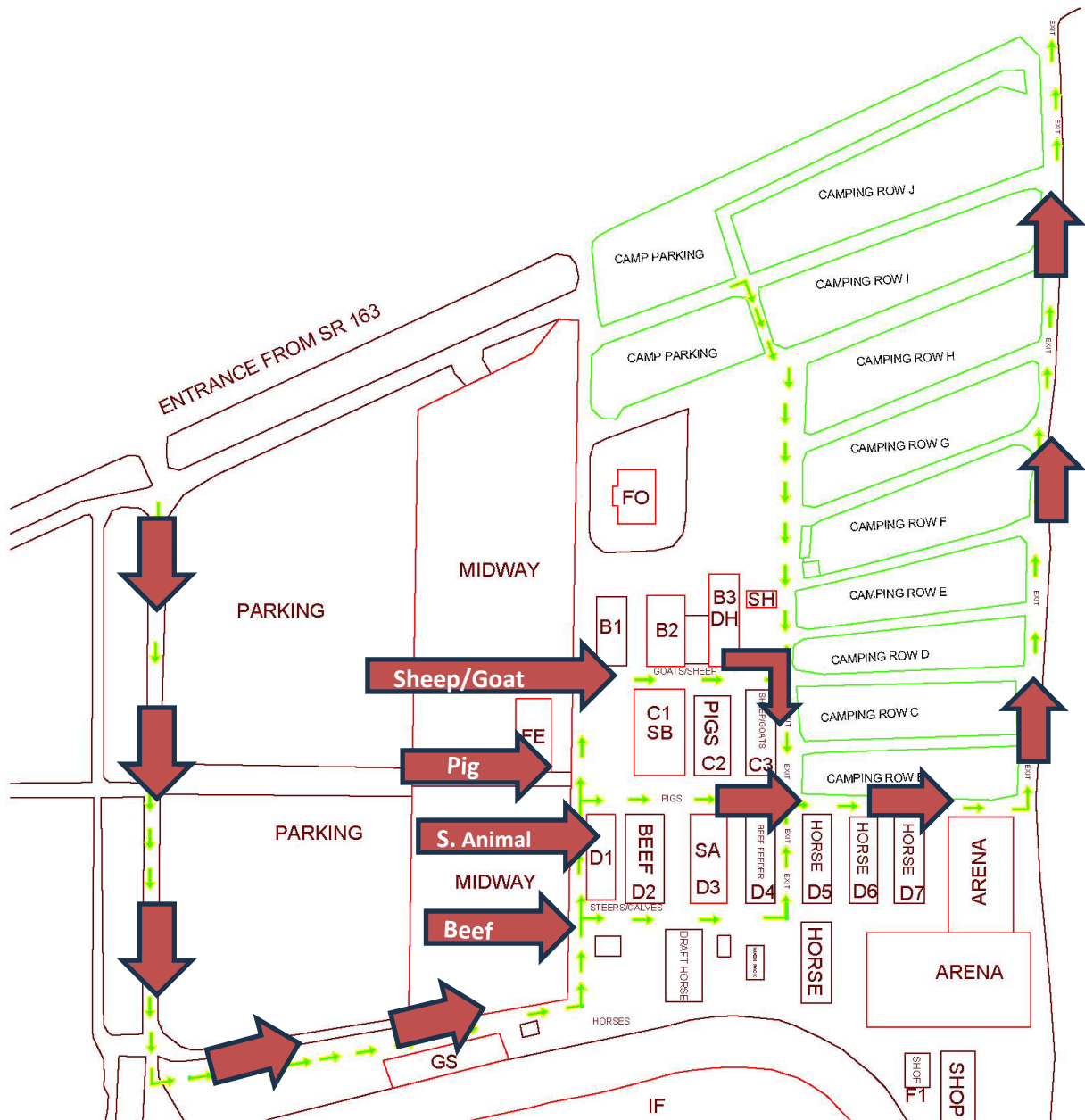

Horses Only

Haul-Out Day
 July 20, 2025
 Starting at **4:00pm**

Producer/Champions

Haul-out Day
 July 20, 2025
 4:00pm

Livestock returning home

Haul-Out Day
 July 20, 2025
 refer to fair schedule

No individual is allowed to drive a vehicle to the livestock barns to pack up until time stated in fair schedule. No exceptions! Tack that you want to remove from barns can be removed on Sunday from 6:00-9:00am OR after the stated time on the fair schedule.

Dept. 1: BEEF

Superintendent: Jerry Buhrow

Assistant Superintendent: Tyler Traver

Jr. Fair Beef Show –Wednesday July 16th 5pm

Rules and Regulations

Read all the Ottawa County Rules & Regulations & Abuse/Harassment Policy

Changes from last year are printed in bold italics!!

1. All rules and regulations listed in this book (pages 1-24) apply to this department.
2. Exhibitors within this department may tag a maximum of 5 animals for that specific project. (Please refer to the Tagging Section of this handbook for more information). Refer to the specific project rule for clarification on the number of animals permitted for each project.
3. All exhibitors must submit an entry and pay their fee in the Online Fair Entry system by June 1st. (Refer to Ottawa County Rules & Regulations - Rule #3) The entry must include all animals they intend to bring to the fair. (You are permitted to enter all 5 of the animals tagged, even if for example only two are coming to the fair.) Make sure to indicate which project/ class you are enrolling each animal for during the enrollment process. Any animal which does not appear in the online database will not be eligible to exhibit.
4. Upon check-in, you will need to show proof of the online Drug Use Notification Form (DUNF) submission and turn in any other Forms.
5. All market animals will be weighed in on Sunday of move-in day. (Please reference times on Traffic & Flow Map) This will be the official weight for the show and sale. There will be no reweighs. All exhibitors must have their animal(s) weighed as this time.
 - a. Beef: Feeder Calves will re-weigh for sale weight upon entrance to the make-up ring at the Back To The Farm Sale.
 - b. Beef: Target weights for Market Heifer show are 1000-1400 lbs. Target weights for Market Steer show weights are 1100-1400 lbs. Feeder calves must weight 450 lbs. or less on tagging day to be eligible for county awards. Exhibitors of overweight feeder calves will only be eligible for showmanship awards. Beef Carcass animals have the same weight limits to be eligible.
6. To promote barn cleanliness, and to meet state guidelines for sanitation and disease control, mulch bedding will be provided for every animal at NO COST to exhibitors. Mulch will be in place upon check-in and no additional bedding in either cattle barn will be permitted.
7. There will be an exhibitor meeting on **Friday, July 11th at 7:30pm** at the steer barn. All beef exhibitors and parents are strongly encouraged to attend. Check-in, show, sale, and exhibit release procedures will be discussed. Stall assignments will be posted at this time, and exhibitors are encouraged to bring stall decorations and tack at the time of the meeting.
8. Pen assignments will be determined by the number of animals exhibited. All pens are assigned by the Beef Barn Superintendents.
9. All market beef animals must be polled or dehorned to be eligible for show. All feeder calves must be polled, dehorned, or have scurs less than two inches. All market beef animals and feeder calves should be dehorned by tagging day.
10. Market Heifers are intended to be fed as a market project and not a breeding animal. Market heifers will be pregnancy checked following check-in at the fair. Any heifer determined to be pregnant will be disqualified from the show and may not be entered into the breeding show.
11. All steers being shown as market beef animals should be castrated by tagging day. It is recommended that feeder calves be castrated by June 1. Any feeder calf showing evidence of testicular tissue will not be eligible for awards.
12. Beef projects will be stalled by club. Exhibitors that desire special stalling arrangements other than by club must indicate the arrangements on their entry and efforts will be made by the superintendent to

accommodate this. All dairy beef feeders will be housed in the feeder barn regardless of requests or other stalling arrangements.

13. Classes will be determined by the superintendent with feeder calves showing by weight and market beef animals showing by weight. Market beef animals will be weighted again on show day upon entering the make-up area, with weights being written on exhibitor's back-tags for judge's information only.

Beef Barn Rules

- Hanging fans only. All fans must be mounted overhead; no fan cart, no box fans on the ground, no fans at stall ends.
- Aisles must be cleaned and wheelbarrows should be emptied daily.
- Deliveries to the barn must be before 9 AM.
- Chutes must be placed in specific areas and not in the wash racks.
- No chute/tack at the ends of the barns, except on show day.
- Animals must have a form of secondary restraint overnight (neck tie/ chain).
- No community water tubs.
- Washing only in specific areas.
- Generators must be used outside of the barn.
- Stall divider gates are available on a first come, first serve basis. They must be attached to the front of the stall.
- If fence posts are used, they must be below the top of the gates.
- Exhibitors must clean up after their animals in the wash rack areas.
- Cattle are not to be walked in other animal barns.
- Stay and help clean up the barn on move out day.

Beef Recommended Show Attire:

Shirt with a collar, jeans (with no holes or tears), and leather type boots

Class 110 Beef Showmanship

Senior Division:	14 yrs. and Older as of Jan 1 st of the current year
Intermediate Division:	11 - 13 yrs as of Jan 1 st of the current year
Beginner Division:	10 yrs and under as of Jan 1 st of the current year

Super Showman

Winners of each age division will compete against each other in a new class to name the Super Showman

BEEF CLASSES AND REQUIREMENTS:

Class 115 Beef Breeding

1. Animals must be in possession by May 1st.
2. Interview Judging – must participate in interview and skill-a-thon during pre-fair judging. Bring completed project book and feed records.
3. Fair Exhibit: Any number of beef breeding animals that fit the eligibility for the classes listed below may be exhibited, given the following provisions are followed:
 - Every female entered in the cow classes must have calf at side or prove to have calved within the last twelve months.
 - Calves shown at the side of cows may also be exhibited in beef calf classes and will be eligible for champion awards as individuals. This is limited to bull Calves and heifer calves that were not exhibited in the feeder calf project. Steer calves, including those shown in the feeder calf project, and heifer calves that are shown in the feeder calf project are eligible for the breeding show only as part of a cow/calf pair and must be exhibited by the owner of the calf.
4. Section listings for Class 115 Beef Breeding
 - 1 Late Junior Bull Calves: born on or after May 1, 2025
 - 2 Early Junior Bull Calves: born from March 1 through April 30, 2025
 - 3 Intermediate Bull Calves: born from January 1 through February 28, 2023
 - 4 Senior Bull Calves: born from Sept. 1, 2022 through December 31, 2022

- 5 Late Junior Yearling Bulls: Born May 1, 2022 through August 31, 2024
- 6 Early Junior Yearling Bulls: born March 1 2022 through April 30, 2024
- 7 Intermediate Yearling Bulls: born January 1 2022 through February 28, 2024
- 8 Senior Yearling Bulls: born Sept. 1 2022 through December 31, 2023
- 9 Late Junior Heifer Calves: born on or after May 1, 2025
- 10 Early Junior Heifer Calves: born from March 1 through April 30, 2025
- 11 Intermediate Heifer Calves: born from January 1 through February 28, 2025
- 12 Senior Heifer Calves: born from Sept. 1, 2024 through December 31, 2024
- 13 Late Junior Yearling Heifers: Born May 1, 2024 through August 31, 2024
- 14 Early Junior Yearling Heifers: born March 1 2023 through April 30, 2023
- 15 Intermediate Yearling Heifers: born January 1 2024 through February 28, 2024
- 16 Senior Yearling Heifers: born Sept. 1 2023 through December 31, 2023
- 17 2-3 Year Old Beef Cows: born on or after January 1, 2022
- 18 Mature Beef Cows: born no later than December 31, 2021

Class 116 Beef Feeder Calf

1. Animal must be in possession by tagging day in May.
 - a. Beef Feeder Calf exhibitors may tag a maximum of 5 animals at tagging in May, which may include any combination of steer and heifer calves. All animals tagged will be eligible to be presented for exhibition in the feeder calf show, with a maximum of 2 calves to be presented at check-in for fair entry.
2. Interview Judging – must participate in interview and skill-a-thon during pre-fair judging. Bring completed project book and feed records.
3. This animal must have at least one parent with full beef bloodlines.
4. Fair Exhibit: Two steer or Two heifer calf weighing 450 pounds or less on tagging day in May.

Section listing for Class 116 Feeder Calf F Beef Feeder Calf

Class 116 Dairy Beef Feeder Calf

1. Animal must be in possession by tagging day in May.
 - a. Dairy Beef Feeder Calf exhibitors may tag a maximum of 5 animals at tagging in May. All animals tagged will be eligible to be presented for exhibition in the dairy feeder calf show, with a maximum of 2 calves to be presented at check-in for fair entry. Heifers are not eligible for the dairy feeder project.
2. Interview Judging – must participate in interview and skill-a-thon during pre-fair judging. Bring completed project book and feed records.
3. This animal must have both parents with full dairy bloodlines.
4. Fair Exhibit: Two dairy steer calves weighing 450 pounds or less on tagging day in May.

Section listing for Class 116 Feeder Calf D Dairy Beef Feeder Calf

Class 117 Market Beef

1. All animals must be in possession by tagging day in December.
 - a. Market Beef / Carcass Beef exhibitors may tag a maximum of 5 animals at tagging in December, which may include any combination of beef steers, beef heifers, and dairy steers. All animals tagged will be eligible to be presented for exhibition in the market beef show or carcass beef evaluation. There will be a maximum of 2 market beef animals to be presented at check-in for fair entry and a maximum of 1 animal to be presented at the check-in for the carcass beef evaluation.
2. Interview Judging – must participate in interview and skill-a-thon during pre-fair judging. Bring completed project book and feed records.
3. Fair Exhibit:
 - a. Market beef animals for exhibit may be beef steers, beef heifers, or dairy steers. All exhibitors may show two market beef animals, which may be any combination of beef steers, beef heifers, and dairy steers.
 - b. Market steers and market heifers must have at least one parent of full beef bloodlines.
 - c. Market Dairy steers must have both parents of full dairy bloodlines.
 - d. Market heifers and dairy steers will show in separate divisions with each winner competing for overall champion market beef.

Section listing for Class 117 Market Beef

- MS Market Steers
- MH Market Heifers
- DS Market Dairy Steers

Section Listing for Class 500 Ottawa County Bred, Born, and Raised Market Beef Classes

- F Beef Feeder Calf
- MB Market Beef

A. Eligibility:

- Ottawa County bred, born, and raised market beef animals, beef and feeder calves are those that were calved by a female that is both owned by an Ottawa County breeder or exhibitor and that was bred (natural, A.I., or embryo transfer), stood the entire gestation in and calved on an Ottawa County farm or the farm of an Ottawa County Jr. Fair Exhibitor.
- The female may have been temporarily removed from the county for breeding or other normal management procedures provided it was temporary and the Ottawa County Breeder or Exhibitor still retained ownership and management of the female.
- Any market animal or feeder calf to be entered in the bred, born and raised class **must be declared at Tagging Day**, and indicated on the Jr. Fair BBR entry form (located at the back of this book) in the appropriate class. Exhibitors designating an animal as bred, born, and raised must submit a breeder verification form which must be signed and returned with their entry form during animal move-in for the fair.
- If the animal designated bred, born, and raised was not bred by the exhibitor or exhibitor's family, then the animal must have been purchased directly from the Ottawa County breeder listed on the breeder verification form.

- B. The animals entered in the Ottawa County bred, born, and raised classes will be designated on the show bill at the fair. This class will be completed after the overall final drive of the market show. This is when the top five bred, born and raised animals will be selected.

Dept. 2: GOATS

Superintendent: Olivia Rahm

Jr. Fair Goat Show –Thursday July 18th at 9:00 am

RULES AND REGULATIONS

Read all the Ottawa County Rules & Regulations & Abuse/Harassment Policy

1. All rules and regulations listed in this book (pages 1-24) apply to this department.
2. Exhibitors within this department may tag a maximum of 5 animals for that specific project. (Please refer to the Tagging Section of this handbook for more information). Refer to the specific project rule for clarification on the number of animals permitted for each project.
3. All exhibitors must submit an entry and pay their fee in the Online Fair Entry system by June 1st. (Refer to Ottawa County Rules & Regulations - Rule #3) The entry must include all animals they intend to bring to the fair. (You are permitted to enter all 5 of the animals tagged, even if for example only two are coming to the fair.) Make sure to indicate which project you are enrolling each animal for during the enrollment process. Any animal which does not appear in the online database will not be eligible to exhibit.
 - All goats/sheep must have an official USDA Scrapie ID tag recorded in the online fair entry system. The Scrapie tag or official permanent scrapie tattoo will serve as the official identification at the fair. This tag must remain in place for the remainder of the project. If the USDA Scrapie ID tag is lost, the exhibitor must notify the Ottawa County Jr. Fair Committee immediately and they will contact the superintendent if tag is lost. In this occurrence, the acquirement of a new tag is the responsibility of the exhibitor. An animal with an improper or missing identification will be disqualified.
4. Upon check-in, you will need to show proof of the online Drug Use Notification Form (DUNF) submission and turn in any other Forms.

5. All market animals will be weighed in on Sunday of move-in day. (Please reference times on Traffic & Flow Map) This will be the official weight for the show and sale. There will be no reweighs. All exhibitors must have their animal(s) weighed as this time.
 - Goat: Minimum weight for meat breeds is 50 lbs. Underweight animals can immediately be taken home at the time of weigh in OR can stay and participate in showmanship class, an underweight class with no awards and cannot sell in the sale.
6. Bedding will be the responsibility of the exhibitor. Exhibitors must have shavings.
7. Pen assignments will be determined by the number of animals exhibited. All pens are assigned by the Goat Barn Superintendents.
8. No barn meeting will be held, there will be a handout with Rules given to every family on move-in day.
9. Showman of Showmen contestant will be the Senior Goat Showman.
10. Hair trimming for Market kids, Harness and Pack Goats is optional. Trimming is strongly recommended if these animals are to be used for showmanship.
11. All goats need to be dehorned or disbudded. In the event of a scurry horn, it must be shorter than 2" and must have a blunt tip. If in doubt, contact the superintendent prior to the fair. Breeding females are allowed to have horns.

Goat Recommended Show Attire:

Jeans/Black pants, button down shirt/white shirt, closed toe shoe.

Goat Showmanship (Class 136):

Senior Division:	14 yrs. and Older as of Jan 1 st of the current year
Intermediate Division:	11 - 13 yrs. as of Jan 1 st of the current year
Junior Division:	10 yrs. and under as of Jan 1 st of the current year

Super Showman

Winners of each age division will compete against each other in a new class to name the Super Showman

GOAT CLASSES & REQUIREMENTS:

Class 134 Market Goat

Section 1 = Market Doe 2= Market Whether

1. Animal in possession by May 1st of current year
2. Exhibit:
 - A. All market goats must be born on or after December 1, 2024 but before April 1, 2025.
 - B. Market goats will be divided into weight classes at fair check in. The Goat Superintendent will **divide them into classes depending on weight**. Weight classes will be posted in the goat barn prior to the show.
 - C. Exhibitors may bring a maximum of two animals to be sold at Livestock Sale. (Exhibitor may choose to bring only one animal).
 - D. All market goats of FULL DAIRY bloodline will be in a separate class.
 - E. *Minimum weight for market goats is 50 pounds. Underweight animals can immediately be taken home at the time of weigh in OR can stay and participate in showmanship class, an underweight class with no awards and cannot sell in the sale.*

Class 134 Breeding Goat

1. Exhibitors may show a maximum of four (4) goats in Jr. Fair of which a maximum of two (2) goats may be in the market goat division. If market goats are not shown an exhibitor may show any combination of four (4) in the breeding and pack classes. Market does cannot be shown in a breeding doe class.
2. Breeding does may have horns
3. All breeding goats MUST have a scrapie tag or tattoo to enter the fair. If proper identification is not visible, you will be asked to remove the goat.
4. Those competing in breeding classes only, are still eligible to participate in showmanship.
5. Market Boer Breeding show will be held after the Market Boer and Born Breed and Raised show.
6. You must enroll in Online Fair Entry System to exhibit at the fair.

Boer and any Boer Crosses / Meat breeds Classes Sections

1. 0-6 mo.
2. 7-12 mo.
3. 13-18 mo.
4. 19-24 mo.
5. 25-36 mo.
6. 37 mo. & older

Junior Champion and Reserve Champion (Classes 1-4)

Senior Champion and Reserve Champion (Classes 5-6)

The Ottawa Co. Ag Society and the Ottawa Co. Jr. Fair are not liable for any damage that may occur to goats having horns, bring at your own risk.

Class 135 Non Market Goats

Section 4 = Dairy Kid

1. Animal in possession by May 1st of current year.
2. Exhibit:
 - A. Doe dropped on or after Jan. 1, 2024 and on or before May 1, 2024.
 - B. Animal must be of full Dairy Blood Line.
 - C. Hair must be trimmed.
 - D. Exhibitors may choose to take either one or two goats

Section 5 = Dairy Yearlings

1. Animal in possession by May 1st of current year.
2. Exhibit:
 - A. Yearling born on or after January 1, 2022 and on or before December 31, 2022
 - B. Animal must be of full Dairy Blood Line.
 - C. Hair must be trimmed.
 - D. Exhibitors may choose to take either one or two goats.

Section 6 = Dairy Goat Production

1. Animal in possession by May 1st of current year.
2. Exhibit: Goat must be in production.
 - A. Animal must be of full Dairy Blood Line.
 - B. Hair must be trimmed.
 - C. Exhibitors may choose to take either one or two goats.

Champion Milk will sell on Friday, July 18, 2025 at Livestock Sale.

Section P1, P2, P3 Pack Goat

1. Animal in possession by May 1st of current year.
2. Exhibitor: Please read the project requirements that come with the project books.
 - A. One whether or doe
 - B. Two or more years in this project must bring the goat from year one. (Years of experience based on the goat not the exhibitor).
 - C. **Section P1 = First year with this project – goat, obstacle course**
 - D. **Section P2 = Second year with this project – same goat, empty pack, obstacle course**
 - E. **Section P3 = Third, or more year with this project – same goat, weighted pack, obstacle course**
3. Pack goats with horns will be eligible, however they maybe asked to be removed in they pose a threat to other animals, people, etc. per the discretion of the Jr. Fair coordinator and Superintendent. They will be required to leave grounds within 12 hours.

Section Listing for Class 500 Ottawa County Bred, Born, and Raised Market Goat Classes

- A. Eligibility:
 - Ottawa County bred, born, and raised market goat animals that is both owned by an Ottawa County breeder or exhibitor and that was bred (natural, A.I., or embryo transfer), stood the entire gestation in and kidded on an Ottawa County farm or the farm of an Ottawa County Jr. Fair Exhibitor.

- The female may have been temporarily removed from the county for breeding or other normal management procedures provided it was temporary and the Ottawa County Breeder or Exhibitor still retained ownership and management of the female.
 - Any animal to be entered in the bred, born and raised class **must be noted** on the Jr. Fair BBR entry form (located at the back of this book) in the appropriate class. Exhibitors designating an animal as bred, born, and raised must submit a breeder verification form which must be signed and returned with their entry form during animal move-in for the fair.
 - If the animal designated bred, born, and raised was not bred by the exhibitor or exhibitor's family, then the animal must have been purchased directly from the Ottawa County breeder listed on the breeder verification form.
- B. The animals entered in the Ottawa County bred, born, and raised classes will be designated on the show bill at the fair. This class will be completed after the overall final drive of the market show. This is when the top five bred, born and raised animals will be selected.

Dept. 3: Sheep

Superintendent: Austin Buhrow
Jr. Fair Sheep Show - Monday July 14th at 9:00 am

RULES AND REGULATIONS

Read all the Ottawa County Rules & Regulations & Abuse/Harassment Policy

1. All rules and regulations listed in this book (pages 1-24) apply to this department.
2. Exhibitors within this department may tag a maximum of 5 animals for that specific project. (Please refer to the Tagging Section of this handbook for more information). Refer to the specific project rule for clarification on the number of animals permitted for each project.
3. All exhibitors must submit an entry and pay their fee in the Online Fair Entry system by June 1st at noon. (Refer to Ottawa County Rules & Regulations - Rule #3) The entry must include all animals they intend to bring to the fair. (You are permitted to enter all 5 of the animals tagged, even if for example only two are coming to the fair.) Make sure to indicate which project you are enrolling each animal for during the enrollment process. Any animal which does not appear in the online database will not be eligible to exhibit.
 - All goats/sheep must have an official USDA Scrapie ID tag recorded in the online fair entry system. The Scrapie tag or official permanent scrapie tattoo will serve as the official identification at the fair. This tag must remain in place for the remainder of the project. If the USDA Scrapie ID tag is lost, the exhibitor must notify the Ottawa County Jr. Fair Committee immediately and they will contact the superintendent if tag is lost. In this occurrence, the acquirement of a new tag is the responsibility of the exhibitor. An animal with an improper or missing identification will be disqualified.
4. Upon check-in, you will need to show proof of the online Drug Use Notification Form (DUNF) submission and turn in any other Forms.
5. All market animals will be weighed in on Sunday of move-in day. (Please reference times on Traffic & Flow Map) This will be the official weight for the show and sale. There will be no reweighs. All exhibitors must have their animal(s) weighed as this time.
 - Sheep: Minimum weights for wool breeds is 40# and minimum weight for meat breeds is 85#. Underweight animals can immediately be taken home at the time of weigh in OR can stay and participate in showmanship class, an underweight class with no awards and cannot sell in the sale.
6. Bedding will be the responsibility of the exhibitor. Exhibitors must have shavings.
7. Pen assignments will be determined by the number of animals exhibited. All pens are assigned by the Sheep Barn Superintendents.
8. No barn meeting will be held, there will be a handout with Rules given to every family on move-in day.
9. There will be a Top 5 Ewe lamb and Top 5 Wether placed. Those ten lambs will then compete for Grand, Reserve, 3rd, 4th, and 5th Overall.

Sheep Barn Rules

- Pens need to be looked at daily and cleaned if needed. Aisle ways need to be kept clean. Aisle cleaning will be assigned by rows of pens for each day.
- Clean, fresh water must be always available.
- Bedding will not be available. You are responsible for your own bedding; Wood shavings will be the only bedding accepted.

Sheep Recommended Show Attire:

Pants/Jeans – Wear nice jeans, No holes, no tears. No shorts/capris/gym shorts. No undergarments may be seen.

Tops – Wear a shirt – polo with collar and sleeves. NO slogans or advertisements (however a 4-H Club or FFA Chapter name is acceptable). NO undergarments may be seen.

No Open Toe Shoes

SHEEP CLASSES AND REQUIREMENTS:

Class 199 Market Lamb Showmanship

Senior Division: 14 yrs. and Older as of Jan 1st of the current year

Intermediate Division: 11 - 13 yrs. as of Jan 1st of the current year

Beginner Division: 10 yrs. and under as of Jan 1st of the current year

Super Showman

Winners of each age division will compete against each other in a new class to name the Super Showman

Class 198 Market Lamb

1. Animal must be in possession by May 1st of the current year.

2. Exhibit: All Exhibitors - one or two lambs (no rams) to be sold at livestock sale.

3. **Minimum weights for wool breeds is 40# and minimum weight for meat breeds is 85#. Underweight animals can immediately be taken home at the time of weigh in OR can stay and participate in showmanship class, an underweight class with no awards and cannot sell in the sale.**

Sections:

1 = Market Lamb – Ewe 2 = Market Lamb – Whether

Class 198 Breeding Sheep

1. Possession date/ownership date/registration transfer date for all junior fair breeding sheep is June 1.
2. Exhibitors may show a maximum of four (4) sheep in Jr. Fair of which a maximum of two (2) sheep may be in the market lamb class. If market lambs are not shown an exhibitor may show any combination of four (4) in the breeding classes (no more than 2 lambs per class). Market ewe cannot be shown in a breeding ewe class.

Breeding Sheep Section

1. Yearling Ewe – 1 year of age but not yet 2 years old
2. Ewe Lamb – Must be born after September 1, 2024

Section Listing for Class 500 Ottawa County Bred, Born, and Raised Sheep Classes

A. Eligibility:

- Ottawa County bred, born, and raised market sheep animals that is both owned by an Ottawa County breeder or exhibitor and that was bred (natural, A.I., or embryo transfer), stood the entire gestation in and kidded on an Ottawa County farm or the farm of an Ottawa County Jr. Fair Exhibitor.
- The female may have been temporarily removed from the county for breeding or other normal management procedures provided it was temporary and the Ottawa County Breeder or Exhibitor still retained ownership and management of the female.
- Any animal to be entered in the bred, born and raised class **must be noted** on the Jr. Fair BBR entry form (located at the back of this book) in the appropriate class. Exhibitors designating an animal as bred, born, and raised must submit a breeder verification form which must be signed and returned with their entry form during animal move-in for the fair.
- If the animal designated bred, born, and raised was not bred by the exhibitor or exhibitor's family, then the animal must have been purchased directly from the Ottawa County breeder listed on the breeder verification form.

B. The animals entered in the Ottawa County bred, born, and raised classes will be designated on the show bill at the fair. This class will be completed after the overall final drive of the market show. This is when the top five bred, born and raised animals will be selected.

Dept. 4: SWINE

Superintendent: Tim Rahm

Assistant Superintendent: Dan Wendt

Jr. Fair Swine Show- Tuesday July 15th at 5:00 pm

RULES AND REGULATIONS

Read all the Ottawa County Rules & Regulations & Abuse/Harassment Policy

1. All rules and regulations listed in this book (pages 1-24) apply to this department.
2. Exhibitors within this department may tag a maximum of 5 animals for that specific project. (Please refer to the Tagging Section of this handbook for more information). Refer to the specific project rule for clarification on the number of animals permitted for each project.
3. All exhibitors must submit an entry and pay their fee in the Online Fair Entry system by June 1st. (Refer to Ottawa County Rules & Regulations - Rule #3) The entry must include all animals they intend to bring to the fair. (You are permitted to enter all 5 of the animals tagged, even if for example only two are coming to the fair.) Make sure to indicate which project you are enrolling each animal for during the enrollment process. Any animal which does not appear in the online database will not be eligible to exhibit.
 1. Hog Identification: Hogs will be tagged at the fairgrounds at a date prior to fair to be determined by the superintendent.
4. Upon check-in, you will need to show proof of the online Drug Use Notification Form (DUNF) submission and turn in any other Forms.
5. All market animals will be weighed in on Sunday of move-in day. (Please reference times on Traffic & Flow Map) This will be the official weight for the show and sale. There will be no reweighs. All exhibitors must have their animal(s) weighed at this time.
 1. Swine: Prior to weigh-in, all hogs MUST arrive at the fairgrounds clean and free from dirt/mud.
 2. Minimum weight is 200 pounds. Underweight animals can immediately be taken home at the time of weigh in OR can stay and participate in showmanship class, an underweight class with no awards and cannot sell in the sale.
6. Bedding will be the responsibility of the exhibitor. Exhibitors must have shavings.
7. There will be an exhibitor meeting on **Friday, July 11th at 7:00pm** at the swine barn. All swine exhibitors and parents are strongly encouraged to attend. Check-in, show, sale, and exhibit release procedures will be discussed. Stall assignments will be posted at this time, and exhibitors are encouraged to bring stall decorations and tack at the time of the meeting.
8. Pen assignments will be determined by the number of animals exhibited. All pens are assigned by the Swine Barn Superintendents.
9. After all weigh-ins, market hogs will be placed in proper classes by sex and weight with approximately 8-10 head per class. The total number of classes offered in the show, may vary depending upon the total number of hogs. Classes will be equalized as evenly as possible, after weighing at the discretion of the Swine Barn Superintendents.
10. The final drive will consist of a top 5 placing with grand and reserve division winners eligible.

Grooming Requirements

Per state regulations, any oil or oil-based products and powder are not permitted.

Optional body clippings of exhibition swine: Only the ears and tails may be clipped under ½ inch.

Feeding/Maintenance

1. It is strongly recommended that all swine be fed by 9 a.m./9 p.m.
2. Mounted feeders are the preferred method for feeding your pigs. No self-feeders holding more than four pounds of feed will be permitted.
3. Those choosing to use rubber pan feeders, are responsible for the removal of pans from their pens.
4. The pens are the sole responsibility of the exhibitor. All pens and aisles should be inspected frequently and cleaned throughout the day.

Class Breakdown

After all weigh-ins, market hogs will be placed in proper classes by sex and weight with approximately 8-10 head per class.

Underweight Hog *not eligible for awards	Less than 200 lbs
Light Weight	200-235 lbs.
Middle Weight	236-265 lbs.
Heavy Weight	266 lbs. and above

Swine Recommended Show Attire:

Shirt with a collar, jeans (with no holes or tears), and leather type boots

Class 140 = Market Hog Showmanship:

- Senior Division: 14 yrs. and Older as of Jan 1st of the current year
- Intermediate Division: 11 - 13 yrs. as of Jan 1st of the current year
- Beginner Division: 10 yrs. and under as of Jan 1st of the current year

Super Showman

Winners of each age division will compete against each other in a new class to name the Super Showman

Class 139 = Market Hog

Section B = Barrow

Section G = Gilt

Class 139 – Breeding Swine

BREEDING GILTS:

1. Exhibitors may show a maximum of four (4) swine in Jr. Fair of which a maximum of two (2) swine may be in the market hog division. If market swine are not shown an exhibitor may show any combination of four (4) in the breeding classes. Market gilts cannot be shown in a breeding gilt class.
2. Breeding gilts must be farrowed on or after December 1 of the prior year
3. Crossbred breeding gilts will show by weight.
4. Breeding gilts must submit Ear Notch before June 1st
5. Breeding gilts are eligible to compete in showmanship classes.
6. You must enroll in Fair Entry to exhibit at the fair.

Section Listing for Class 500 Ottawa County Bred, Born, and Raised Swine Classes

A. Eligibility:

- Ottawa County bred, born, and raised market swine animals that is both owned by an Ottawa County breeder or exhibitor and that was bred (natural, A.I., or embryo transfer), stood the entire gestation in and born on an Ottawa County farm or the farm of an Ottawa County Jr. Fair Exhibitor.

- The female may have been temporarily removed from the county for breeding or other normal management procedures provided it was temporary and the Ottawa County Breeder or Exhibitor still retained ownership and management of the female.
 - Any animal to be entered in the bred, born and raised class **must be noted** on the Jr. Fair BBR entry form (located at the back of this book) in the appropriate class. Exhibitors designating an animal as bred, born, and raised must submit a breeder verification form which must be signed and returned with their entry form during animal move-in for the fair.
 - If the animal designated bred, born, and raised was not bred by the exhibitor or exhibitor's family, then the animal must have been purchased directly from the Ottawa County breeder listed on the breeder verification form.
- B. The animals entered in the Ottawa County bred, born, and raised classes will be designated on the show bill at the fair. This class will be completed after the overall final drive of the market show. This is when the top five bred, born and raised animals will be selected.

Dept. 5: SMALL ANIMAL - POULTRY

Superintendent: Anna Brandt
Assistant Superintendent: Christie Wolf
Jr. Fair Show – Tuesday July 15th 9am

Read all of the Ottawa County Rules & Regulations & Abuse/Harassment Policy

RULES AND REGULATIONS:

1. All rules and regulations listed in this book (pages 1-24) apply to this department.
2. All exhibitors must submit an entry and pay their fee into the Online Fair Entry system by June 1st at noon. (Refer to Ottawa County Rules & Regulations - Rule #3) The entry must include all animals they intend to bring to the fair. Make sure to indicate which project you are enrolling each animal for during the enrollment process. Any animal which does not appear in the online database will not be eligible to exhibit.
3. Upon check-in, you will need to show proof of the online Drug Use Notification Form (DUNF) submission and turn in any other Forms.
4. Market animals will not be weighed.
5. An exhibitors meeting will be held in the Show Barn at 5:30 pm the evening of check-in.
6. Show bills will be posted prior to the show in the Small Animal Barn
7. The Judge has the option to use the American Standard of Perfection as a reference during judging.

Barn Rules

- Feed and water containers are provided at no cost to the exhibitor. Exhibitor **MUST** clean at the end of the fair.
- Floor pens need cleaned every day. Please refer to page 10 of the 2025 Ottawa County Fair Health Regulations.
- You are required to regularly check your animals for fresh water

Poultry Recommended Show Attire

Long sleeve white shirt with a collar, jeans (with no holes or tears), and leather type boots

Class 150 Section 151 Poultry Showmanship

There will be three classes of Showmanship. Bring only one bird to the ring.

Senior Division:	14 yrs. and Older as of Jan 1 st of the current year
Intermediate Division:	11 - 13 yrs as of Jan 1 st of the current year
Beginner Division:	10 yrs and under as of Jan 1 st of the current year

Super Showman

Winners of each age division will compete against each other in a new class to name the Super Showman

POULTRY CLASSES & SECTIONS:

Class 150 Section CEP1 Egg Production: Pullets

1. Pen of 2 pullets of the same breed and variety.
2. Raised from less than 1 week old.
3. Recommended age at Fair time is 21 weeks but must be less than 1-year-old.
4. If you plan to take egg production, you must take this section the year prior.

Class 150 Section CEP2 Egg Production: Hens

1. *Chicken production class is a required prerequisite.*
2. Pen of two hens of the same breed and variety.
3. Exhibitors can take 2 pens of pullets **BUT** they must be of different breeds
4. Hens must have a negative Pullorum test and bring papers to Fair.
5. The hens exhibited at the Fair must be in production and have a presentable condition. (No bare back hens.) The Fair Veterinarian reserves the right to reject any entry, if in his/her opinion, is for the betterment of the show.
6. Bring one dozen eggs produced by hens in this project on show day only.
7. Champion and Reserve Champion eggs will be sold at livestock sale. The exhibitor will receive the money.

Class 150 Section CM1 Broilers

1. Possession date is June 1st of the current year.
2. One pen of two pullets or two cockerels of the same breed and variety (cockerels recommended).
3. Must be commercial meat breeds only.
4. Raised from less than 1 week old.
5. Recommended age at Fair time is 6-8 weeks.
6. Birds will be sold at the livestock sale. Exhibitors are responsible for dressing & delivering birds to the buyer after the Fair.

Class 150 Section CE1 = Exhibition Fancy Poultry Large Fowl Section CE2 = Bantam Fancy Poultry

1. Pen of two, male and female of the same breed and variety.
2. Standards and bantams may be shown; there will be two classes. You may show in both classes.
3. Raised from less than one week old.
4. Exhibitors can take 2 pens of fancy **BUT** they must be of different breeds

Class 150 Section TM Market Turkey

1. Pen of one turkey (recommend white male).
2. Raised from less than one week.
3. Recommended weight at Fair is 25-35 lbs. pounds for market birds only.
4. Exhibitors are responsible for dressing & delivering birds to the buyer after the Fair.
5. All Market Turkeys will be sold at the Jr. Livestock Sale.

Class 150 Section TE1 Breeder Market Turkey Section TE2 Breeder Turkey

1. Pen of two (one male & one female, same breed & variety).
2. These birds will not be sold at the Fair.
3. Recommended age for the Fair is a minimum of 22 weeks and up.

Class 150 Section DE1 Heavy Duck Section DE2 Medium Duck Section DE3 Light Duck Section DE4 Bantam Duck

1. One male and one female of the same breed and variety.
2. Raised from less than one week old but must be less than two years old at the Fair.
3. There will be four classes: Heavy, Medium, Light, and Bantam
 - Heavy – Aylesbury, Muscovy, Pekin, Rouen
 - Medium – Buff, Cayuga, Crested, Swedish
 - Light – Campbells, Magpie, Runners
 - Bantam – Calls, East Indie, Mallards

4. Exhibitor may show in more than one class.
5. Awards for top 5 in each class, the top 2 will compete for Champion & Reserve Champion.

Class 150 Section DM1 Market Duck

1. One pen *of 2 ducks*. Pen must weigh a minimum of 15 lbs.
2. Raised from less than 1 week old.
3. Recommended age of the ducks at fair time is 8 weeks old.

Class 170 Section 1 Pigeons

1. Pen of two squabs or one male and one female, pigeons of the same breed and variety.
2. Birds must be in your possession by May 1.
 3. Seamless banded if possible.

CLASS 170 SECTION 2 Helmeted Guinea Fowl

1. Exhibit a pair, one male and one female of the same breed.

**Class 169 Section 1 Exhibition Heavy Goose
 Section 2 Exhibition Medium Goose
 Section 3 Exhibition Light Goose**

1. Pen of one, no more than two in a class.
2. Raised from less than one week old, recommended less than two years old at the Fair.
3. There will be three classes: Heavy, Medium, and Light
 - Heavy – African, Embden, Toulouse
 - Medium – American Buff, Pilgrim, Pomeranian, Sebastopol
 - Light – Canada, Chinese, Egyptian, Tufted Roman
4. Exhibitor may show in more than one class.
5. Awards for top 5 in each class, the top 2 will compete for Champion & Reserve Champion.

Class 150 Section GM Market Goose

1. One goose. The goose must weigh a minimum of 9 lbs.
2. Raised from less than 1 week old.
3. Recommended age of the goose at fair is 10-13 weeks old.

Dept. 6: SMALL ANIMAL - RABBITS

Superintendent: Anna Brandt

Assistant Superintendent: Christie Wolf

Jr. Fair Rabbit Show – Wednesday July 16th at 9:00 AM

RULES AND REGULATIONS

Read all the Ottawa County Rules & Regulations & Abuse/Harassment Policy

1. All rules and regulations listed in this book (pages 1-24) apply to this department.
2. All exhibitors must submit an entry and pay their fee into the Online Fair Entry system by June 1st at noon. (Refer to Ottawa County Rules & Regulations - Rule #3) The entry must include all animals they intend to bring to the fair. Make sure to indicate which project you are enrolling each animal for during the enrollment process. Any animal which does not appear in the online database will not be eligible to exhibit.
 - a. When filling out the online entry, the exhibitor can enter only 8 breeding animals' tattoos. For those 8 rabbits, the exhibitor must write down the tattoo, the breed, and the class it would show under (Ex: Jr. Buck, Sr. Doe). The exhibitor can still only bring one rabbit per class, but the rabbit must match the tattoo and description that they put on their entry form.
3. Upon check-in, you will need to show proof of the online Drug Use Notification Form (DUNF) submission and turn in any other Forms.

4. All rabbits must have a readable tattoo in the left ear. All rabbits must be brought to tattooing to be checked to verify tattoo and make sure that the tattoo is readable. Tattoo Date for rabbits will be set later. Please watch the Ohio State-Ottawa County 4-H Facebook page for updates
5. Commercial Pens will be weighed at check-in. This will be the official weight for the show and sale.
 - a. Over and underweight commercial pens will be sold at the livestock sale
6. Show bills will be posted prior to the show in the Small Animal Barn
7. The Judge has the option of using the ARBA Standard of Perfection as a reference during the judging

**Pet rabbits are NOT part of this department.

Rabbit Barn Rules

- Keep barn clean, floor swept and if you see garbage, please pick it up and throw away.
- Animals are to always have water. Please feed in the morning and at night.
- No bedding (straw, shavings, etc.) will be allowed in the cages, only underneath the pens. Exhibitors will be allowed to place boards or mats in cages.
- All items displayed (i.e. signs, decorations, etc.) in the rabbit barn are at the discretion of the superintendent. All signs and decoration must be hung in front of exhibitor cages.
- Respect others. If you have an issue with someone, you will need to speak to the barn superintendent. If the matter cannot be resolved, the matter will be turned over to the Jr. Fair Committee.
- Please remember – it's all about TEAMWORK!
- Classes will not be held if you are not present.

Recommended Show Attire:

Long sleeve shirt with a collar (or a polo with a white show jacket), jeans (with no holes or tears), and leather type boots

Class 227 = RABBIT SHOWMANSHIP

Senior Division:	14 yrs. and Older as of Jan 1 st of the current year
Intermediate Division:	11 - 13 yrs. as of Jan 1 st of the current year
Beginner Division:	10 yrs. and under as of Jan 1 st of the current year

Super Showman

Winners of each age division will compete against each other in a new class to name the Super Showman

RABBIT CLASSES & SECTIONS:

Class 225 Breeding Rabbit:

Exhibitors only allowed one entry per class. Animals must be in possession on or before May 1st of the current year.

Sections:

- 1: Sr. Buck – 6 months of age and older as of check-in date
- 2: Sr. Doe – 6 months of age and older as of check-in date
- 3: Jr. Buck – Under 6 months of age as of check-in date
- 4: Jr. Doe – Under 6 months of age as of check-in date

Class 226 Market Rabbit

Must be in possession by the Tattooing date of the current year

Sections:

- **1: Commercial Pen** – Must be a pen of three commercial meat breed of rabbit not over 69 days old as of the Fair. Rabbits must weigh no less than 3 pounds each and no more than 5 pounds each. Animals need to be of the same breed, color, variety or group. Only one commercial meat pen per exhibitor. Pen of three will be sold at the Fair. This pen will sell at the livestock sale.
- **2: Single Fryer** – Exhibitors choose one of the rabbits shown in the commercial pen class. The single fryer must be 1 of the 3 rabbits shown in the commercial pen class. This class does not sell at the sale.

- If you are registered for BOTH commercial pen and single fryer, in the event you are unable to bring your commercial pen, you would still be eligible to bring a single fryer.
- **3. Market Roaster Class** – This class will sell at the auction.

	Age	Ideal	Acceptable	Unacceptable
Fryers	8-10 weeks old	3-5 lbs.	3-5 lbs.	Under 3lbs over 5lbs
Roasters	Under 6 months	6-8 lbs.	5-8 lbs.	Under 5lbs over 8lbs
Commercial	69 days old on day of fair	3-5 lbs.		

Dept. 7: Alpaca/Llama

If interest arises, we will discuss exhibition and show possibilities

Dept. 8: SADDLE HORSES AND PONIES

Superintendent: Adam Steinmiller

Assistant Superintendent: Emma Steinmiller and Anthony Stout

Jr. Fair Show – See Fair Schedule

Each show day begins at 9:00 am

Opening Ceremony begins at 8:30 am each day.

RULES AND REGULATIONS

Read all the Ottawa County Rules & Regulations & Abuse/Harassment Policy

1. Ownership – the date established for having possession of a horse by an Ottawa County Jr. Fair participant is May 1, of the current year. The Ottawa County rule for replacement of animals is as follows:
 - A. Jr. Fair horse show participant may replace his or her animal after the stated date (Horse-May) if loss is due to injury, death, or extreme sickness. Those who choose to show the replacement animal at the Fair are eligible for an A, B & C grade only. They are only eligible for Showmanship awards.
2. HORSE ID CARDS (that you received with your project): All horses will be identified by completing a horse ID form. Each horse ID paper must have a current year photo of the animal attached. This is done online via Qualtrics
3. The photo or photos should be a view that shows the full body, face, and all 4 legs . All horse ID forms, photo IDs, and lease agreements must be postmarked or turned into the Extension Office, attention Junior Fair Coordination, by May 1st. If those items are turned in after May 8th, the exhibitor will NOT be eligible for county awards or to be an Ottawa County Rep. to the Ohio State Fair 4-H Horse Show. A copy of the lease must accompany the ID form if the horse is not owned by the exhibitor or the exhibitor’s immediate family, as defined by the ODA’s Tampering Exhibition rules.
4. Each exhibitor may identify a maximum of **five horses** prior to the May 1 deadline. Each exhibitor must select a maximum of two horses to enter in the fair entry system by June 1. 4-H horse exhibitors are limited to stall two equines for the week of the fair.
5. It is encouraged for each family to purchase a 4-H Uniform Rule Handbook and mandatory for each club to purchase one.
6. An entry fee of \$10 per animal will be collected when you complete the online entries into Fair Entry system, due June 1st. Late entries will be charged a \$50.00 late fee until June 8th. After June 8, no entries will be accepted and will result in denial of entry into the Ottawa County Fair.
7. Each equine project must have a body score of 4 or higher to exhibit at the Ottawa County Fair. It is **highly recommended** to attend Horse Advisory optional body score day, it is **mandatory** that all equine projects are to be checked at the Mandatory Body Scoring Day, date to be posted.
8. An advisor must be present and sign off on witnessing ***each horse and rider pair at two of the following: club work sessions, county work sessions, or horse shows or open rides.*** If you do not complete this requirement, then you will not be eligible to show at the fair. ***Failure to provide rider log documentation at the time of move in will result in denial of entry into the Ottawa County Fair.***

9. A member must exhibit and participate in the Ottawa County Jr. Fair to be eligible to compete at the Ohio State Fair, ***with the exception of years when the Ohio State Fair 4-H Horse Shows are during the Ottawa County Fair.***
10. An exhibitor may show one saddle horse per class. Equine reproduction and Draft may have two per class.
11. An exhibitor may not show in both a pony and a horse class with the same animal.
12. **An exhibitor can only do 1 discipline between Western and Ranch. They cannot cross disciplines with the same horse.**
13. For those horses exhibited at the Fair, the member must show their horse in at least two classes. The second horse (if applicable) must be shown in at least one class. Choice of classes is optional. This does not apply to Equine Reproduction, which will show in appropriate Production Class.
14. **Entry forms must be filled out and returned to the booth the night prior to the next show day.**
15. You may not scratch any classes, unless there is a safety issue or if there is an injury or illness to the exhibitor or horse. Scratches are discouraged, once you sign-up for the event, you are signed up. An unexcused (as determined by the Superintendent) scratch from a 4H show will cause you to not place in your next class. 2 scratches on the same horse in the same day will cause you to not place in your next 2 classes. 3 scratches in one day on the same horse, you will not be able to show the remainder of the week.
16. Only the 4-H horse project member is allowed on the project horse and handling of the project horse during the Junior Fair until all Junior Horse Classes are finished. Violation of this rule will result in an exhibitor being disqualified for the remaining of the Junior Fair Horse Classes. Exception of this would be for safety concerns and Horse Superintendent can make final decision.
17. Showman of Showmen: The top 2 in each of the following classes will compete; Senior English Showman, Senior Western Showman, Senior Ranch Showman and Senior Contesting Showman. Exhibitor may only enter one of the following showmanship classes with the same horse, Western, Ranch, and Contesting.
18. Outstanding Exhibitor: Will use Showmanship, Skillathon and your top-class score. You must choose 1 showmanship class, and 1 class, and the horse that you want to count towards your score. Choices must be made by the night of Skillathon. You must enter all 3 choices to be eligible for Outstanding Exhibitor.
19. Horsemanship: You can only do one Horsemanship class with the same horse, must choose from Western, ranch and Contesting. There will be a pattern in these classes.
20. Gymkhana Classes: For any reason the timer has to be moved after the class has started:
 - Everyone in the class that has already ran must rerun (no ride times will be recorded).
 - Anyone that had a clean run (meaning that no penalty occurred during the run) and the rider incurs a penalty on the rerun, then that rider will be given a 2nd rerun. This will be their final ride. There will be no 2nd rerun if 1st rerun isn't clean (cannot try a 2nd run for a better time).
 - IF the rider incurred a penalty on their ride, then they will be given only one rerun.
 - A horse that runs or backs into the fence at anytime due to lack of control or disobedience while in the arena will be disqualified.
21. Organizing and conducting of the Jr. Fair Horse show is the responsibility of the Jr. Fair Horse Superintendent and Assistant Horse Superintendents. The Horse Superintendent reserves the right to combine, cancel or split classes. The Ottawa County Jr. Fair Horse Judging will follow "Uniform Rules for 4-H Horse Shows".
22. The Judge's decisions will be final.
23. Inhumane (as determined by show management) methods of schooling or showing are not allowed.
24. Unsportsmanlike conduct towards judges, show management or exhibitors will not be tolerated. Violators will be dismissed from the show and/or subject to further actions.
25. **Any complaints or disagreements will be handled after the show. Disagreements and complaints are to be brought to the superintendent by a 4-H Advisor only.**
 - **Failure to follow this rule could result in the removal from the fair.**
26. Trainers are only SPECTATORS during the shows and should not be in the barns during the shows their youth are participating in.
 - Trainers should NOT be getting the horse ready for show, they are able to complete safety checks when the horse is prepared but should be done in a public area.
27. **Excessive coaching is prohibited during the show.**

Horse Exhibitor (and family) potluck will be on Sunday July 13th at 5:00 pm at the horse area and the exhibitor meeting will be at 6:00pm

*****Refer to the newest printing of the Uniform Rules for Horse Shows.**

Sr. and Jr. Gymkhana high points based on point values for placings in all timed classes.

Section 173 Horseless Horse – This project will be judged on Monday , July 7th, 2025. Check in an educational display or poster board on one of the units in the project book to be displayed during the whole Fair, in the small animal barn.

WALK TROT (BEGINNER RIDER)

- Class is designed for a beginning rider who does not have the skills, confidence, or has a safety issue to ride in the canter classes.
- The rider is not eligible to ride in any other canter class.
- Riders can exhibit in any tack discipline tack with appropriate attire.
- At the judge's discretion a back may also be included.

WALK TROT (BEGINNER HORSE)

- Class is designed for an experienced rider exhibiting an inexperienced horse, as a training experience.
- The horse is not eligible to be ridden in any other canter class.
- Riders can exhibit in any tack discipline tack with appropriate attire.
- If the horse is five years of age or under, it may be ridden with two hands on the reins and in a snaffle bit.
- At the judge's discretion a back may also be included.

CONTESTING HORSEMANSHIP

- Exhibitors will show this class in same equipment/tack and apparel as the other contesting classes. Refer to Gymkhana rules in the Uniform Horse Rule Book.
- Must enter at least 1 other riding Contesting Class

CLASSICAL/WESTERN DRESSAGE

Exhibitors wanting to participate in Dressage/Western Dressage will provide their own LEGIBLE test to the show office NO later than **5 pm on Sunday** of move in day. Failure to do so will result in the exhibitor being disqualified. Competitors are responsible for prior knowledge of all rules for dressage competition.

TEAM TOURNAMENT

Exhibitors must be signed up with shirt size by Skillathon. Teams will be drawn on Sunday of check in. Team meeting and making of team shirts will be held at 6pm on Sunday, at this time teams will enter the events. Team Tournament competition will take place on Wednesday at 7 pm

Monday - 9:00 a.m.

1. Sr. Contesting Showmanship
2. Jr. Contesting Showmanship
3. Sr. Western Showmanship
4. Jr. Western Showmanship
5. Horseless Horse Showmanship
6. Sr. English Showmanship
7. Jr. English Showmanship
8. Sr. Ranch Showmanship
9. Jr. Ranch Showmanship
10. Draft Showmanship
11. Assisted Showmanship English/Western
12. Sr. Super Showmanship Class (All 1st and 2nd place from Jr. and Sr. classes)
13. Jr. Super Showmanship Class (All 1st and 2nd place from Jr. and Sr. classes)
14. Walk-Trot Equitation (Beginner Rider)
15. Walk-Trot Equitation (Beginner Horse)

16. Sr. English Equitation
17. Jr. English Equitation
18. Sr. Easy-Gaited Equitation
19. Jr. Easy-Gaited Equitation
20. Sr. Hunter Under Saddle
21. Jr. Hunter Under Saddle
22. Pony Hunter Under Saddle
23. Walk-Trot Hunter Under Saddle (Beginner Rider)
24. Walk-Trot Hunter Under Saddle (Beginner Horse)
25. Sr. Easy-Gaited Pleasure
26. Jr. Easy-Gaited Pleasure
27. Sr. Hunter Hack
28. Jr. Hunter Hack
29. Beginner Cross Rails (cannot enter in any other jumping class)
30. Equitation Over Fences
 - A. Novice
 - B. Intermediate
 - C. Advanced
31. Hunter Over Fences
 - A. Green Hunter
 - B. Low Hunter
 - C. Regular Hunter
32. Mini Horse Jumping
33. Sr. Dressage
34. Jr. Dressage
35. Pleasure Driving - Light H/P
36. Driving Reinsmanship - Draft H/P
37. Driving Reinsmanship - Light H/P
38. Single Hitch Draft Driving
39. Driven Trail - Light H/P
40. Driven Trail - Draft H/P
41. Light Horse Single Hitch
42. Draft Team Hitch
43. Weanling Production
44. Yearling Production
45. Yearling Lunge Line

Tuesday - 9:00 a.m.

46. Sr. Trail In-Hand
47. Jr. Trail In-Hand
48. Western Sr. Trail
49. Western Jr. Trail

50. Sr. Ranch Trail

51. Jr. Ranch Trail

52. Walk-Trot Horsemanship (Beginner Rider)

53. Walk-Trot Horsemanship (Beginner Horse)

54. Walk-Trot Ranch Horsemanship (Beginner Rider)

55. Walk-Trot Ranch Horsemanship (Beginner Horse)

56. Horseless Horse Walk-Trot English/Western

57. Assisted Walk-Trot English/Western

58. Sr. Western Horsemanship

59. Sr. Contesting Horsemanship

60. Jr. Western Horsemanship

61. Jr. Contesting Horsemanship

62. Sr. Easy-Gaited Horsemanship

63. Jr. Easy-Gaited Horsemanship

64. Sr. Western Pleasure

65. Jr. Western Pleasure

66. Pony Western Pleasure

67. Walk-Trot Western Pleasure (Beginner Rider)

68. Walk-Trot Western Pleasure (Beginner Horse)

69. Sr. Western Dressage

70. Jr. Western Dressage

71. Sr. Western Riding

72. Jr. Western Riding

73. Sr. Ranch Horsemanship

74. Jr. Ranch Horsemanship

75. Sr. Ranch Riding

76. Jr. Ranch Riding

77. Walk-Trot Ranch Horse Pleasure (Beginner Rider)

78. Walk-Trot Ranch Horse Pleasure (Beginner Horse)

79. Sr. Ranch Horse Pleasure

80. Jr. Ranch Horse Pleasure

Wednesday - 9:00 a.m.

81. Sr. Pole Bending

82. Jr. Pole Bending

83. Walk-Trot Pole Bending (Beginner rider with 1-2 years experience)

84. Sr. Stakes

85. Jr. Stakes

86. Sr. Keyhole

87. Jr. Keyhole

88. Sr. Barrels

89. Jr. Barrels

90. Walk-Trot Barrels (Beginner rider with 1-2 years experience)

91. Sr. Flags
92. Jr. Flags
93. Walk-Trot Flags (Beginner rider with 1-2 years experience)
94. Sr. Cones and Barrels
95. Jr. Cones and Barrels
96. Sr. Speed and Control
97. Jr. Speed and Control
98. Relay Race

*****Showmanship: Every Exhibitor MUST choose at least one showmanship class. With the exception of a state qualified horse that is showing at state on Monday. You cannot do both Western, Ranch and Contesting Showmanship with the same horse.**

Dept. 10: Carcass

****The date for drop off is July 7th with judging on the 9th. Please watch the Ohio State – Ottawa County 4-H page for updates regarding times on those days.****

1. Exhibitors must have completed one (1) years of project experience in this species prior to January 1st of the current year or be at least 15 years old and have one (1) year of project experience in this species prior to January 1 of the current year.
2. All carcass animals must be in possession by tagging day and tagged on the determined date.
3. Online Fair Entry carcass entry must be completed to be eligible for carcass class by entry deadline.
4. Carcass exhibitors **must prepare a poster** about the species industry to be turned in on the day the animal is dropped off for the carcass contest.
5. Upon arrival of carcass animal, the processing card must be completed and turned into the superintendent.
6. Carcass exhibitors must participate in a species skill-a-thon judging. Exhibitors must bring completed project book and feed records.
7. Only the grand champion and reserve champion carcasses will be sold at the livestock sale and be eligible for add-on sales. All others will be processed according to cutting cards.
8. Carcass exhibitors must attend carcass results to be eligible for awards, if not in attendance; the next placed animal will be awarded.

Class 119 Beef Carcass Evaluation

1. Beef carcass exhibitors may bring only one of the following animals: beef steer, beef heifer or a dairy steer.
2. Only 7 animals, or number determined by the processor, will be eligible for the county carcass contest. If more than 7 animals, or number determined by the processor are entered in the contest, the underweight animals will be eliminated first, if necessary, a live evaluation will take place to eliminate further. Eliminated animals will return home.
3. The minimum weight limit for a steer is 1,100 pounds and 1,000 for a heifer.

Class 200 Lamb Carcass Evaluation

1. Exhibitor may bring only one lamb (whether or ewe) for carcass contest
2. Live weight cannot be less than 95 pounds, but cannot be greater than 150 pounds.
3. Only 6 animals, or number determined by the processor, will be eligible for the county carcass contest. If more than 6 animals, or number determined by the processor are entered in the contest. The under and overweight animals will be eliminated first, if necessary, a live evaluation will take place to eliminate further. Eliminated animals will return home.

Class 143= Barrow Carcass Evaluation

1. Exhibitor may bring only one barrow for carcass contest.
2. Only 15 animals, or number determined by the processor, will be eligible for the county carcass contest. If more than 15 animals, or number determined by the processor are entered in the contest. The underweight animals will be eliminated first, if necessary, the animals closest to 245# will be eligible for the carcass contest.
3. Barrow live weight must be a minimum of 210 pounds.

FFA CROPS & SHOP EXHIBITION REQUIREMENTS

You **MUST** enroll in each section that you plan on entering at the fair. If you are not enrolled in the section, you will NOT be eligible for judging at the fair, nor eligible for a premium. Judging for all FFA will be **Monday, July 14, 2025 - 8:00 a.m.**

Dept. 46: FFA FIELD CROPS

Section 711 Wheat – Fair exhibit: Any variety – 1 quarts

Section 715 Corn – Fair exhibit 3 stalks of corn: any variety, suggest tied bag to be used to contain roots.

Section 716 Soybeans – Fair exhibit 3 stalks of soybeans, suggest burlap bag to be used to contain roots.

Section 717 Hay - Fair exhibit: any variety, 8 – 10-inch slice from machine made bale of hay.

Section 721 Vegetables – Fair Exhibit: 3 vegetables of the same type. Can be entered multiple times.

Section 722 Fruits – Fair Exhibit: 3 fruits of the same type. Can be entered multiple times.

Section 723 Miscellaneous Crops – Crops that are not listed above, please check with advisor to see requirements for this project.

Dept. 46: FFA WELDING

Small projects – Construction value \$0 to \$25

Medium projects – Construction value \$26 - \$125

Large projects – Construction value \$126 and up

Section 730 Welding Panel – Fair exhibit: A 3-inch-long butt, 3 inch long lap, and 3 inch long T weld on 1/8 to 3/8 inch thick metal showing starting and stopping of weld, mounted on up to 6 inch X 12 inch panel.

Section 736 Small Electric Panel

Section 740 Small Metal

Section 741 Medium Metal

Section 742 Large Metal

Section 749 Plumbing

Dept. 48: FFA WOODWORKING

Small projects – Construction value \$0 to \$25

Medium projects – Construction value \$26 - \$125

Large projects – Construction value \$126 and up

Section 745 Small Woodworking Projects

Section 746 Medium Woodworking Projects

Section 747 Large Woodworking Projects

Dept. 49: FFA PROJECTS

Section 750 Irrigation Board Projects – Fair exhibit: Irrigation system including irrigation piping and complete system mounted on a board.

Section 744 Tap Block Projects – Fair exhibit: A bar of metal approx. 6 inches long x222 inches wide and .5-inch-thick that is drilled, tapped, and labeled with ¼ thru ½ inch fine and course threads.

Section 748 Outdoor Lighting Board Projects – Fair exhibit: Outdoor landscape project including transformer, and low voltage light fixture.

Section 982 Container Garden Projects – Fair exhibit: Any plant grown in a potted container.

Section 984 Landscape Design Projects – Fair exhibit: Plans for landscaping a commercial or residential property.

Section 980 Live Floral Arrangement Projects – Fair exhibit: Arrangement of live flowers for display.

Section 981 Artificial Floral Arrangement Projects – Fair exhibit: Arrangement of artificial flowers for display.

Section 985 Miscellaneous FFA Project – Fair exhibit

Ottawa Co. Jr. Fair Overnight Policy

I give permission for _____ to stay in the _____ barn on the following night(s):
(Exhibitor's Name)

(Please check the night(s) you will be staying in the barn)

- Monday, July 14
- Tuesday, July 15
- Wednesday, July 16
- Thursday, July 17
- Friday, July 18
- Saturday, July 19

Junior Fair Livestock exhibitors wanting to stay overnight in the barns must:

1. Be enrolled in a livestock/horse project in that barn.
2. Not have in their possession any tobacco products, alcoholic beverages or illegal drugs of any kind.
3. Only those 4-H/FFA members with permission slips on file at the Jr. Fair Board office are allowed to stay in the barns.
4. Come to the Jr. Fair Board office daily to receive a wrist bracelet for identification as an overnighiter.
5. Be in the barn by quiet hours as set by the fair schedule.

By signing this form, I understand and will follow the rules stated above and the rules stated in the premium book.

Exhibitor: _____

Parent/Legal Guardian: _____

Anyone who is in violation of the Overnight Policy will be asked to leave the fairgrounds, after contacting their parent/guardian to inform them of the violation.

**This form must be returned to
Jr. Fair Coordination,
Mail to: c/o Ottawa Co. Ag Society, JFC
7870 W. SR 163, Oak Harbor, OH 43449**

Turn in this form and get your barn wristband before sleeping in the barns!

FORMS SECTION

You can find information on the Fair's website at

www.ottawacountyfair.org/forms

For the following forms:

Bakers Roundup
County Cuties Contest
Future King & Queen
Hog Calling

BOOTH ENTRY

Deadline: JUNE 15th

Booth sizes available: 8 Feet - 12 Feet - Need to discuss a larger booth

- Booth Entry for FFA/4-H Clubs/Scout troops to exhibit in B2
- Booth set up will be Saturday, **July 12, 2025 from 8:00am-1:00pm.**
- Each club that exhibits a booth will receive a \$15.00 premium, which will be available in the booth barn at the completion of booth tear down. This \$15.00 premium will be forfeited if any items are removed from the booth prior to dismantle time. Any money not picked up by move out day will be considered a donation to Jr. Fair. Dismantle time for booths is Sunday, **July 20, 2025 at 6:00 p.m (or the time designated on the official fair schedule).** NO EARLIER!!!
- By signing this form, you agree to NOT dismantle your booth earlier than the set dismantling time.

Register for a booth at: www.go.osu.edu/ocfairbooth

or scan QR code



JR. FAIR BOOTH JUDGING

Award: The top 25% of the Jr. Fair Booths will receive an outstanding banner. Judging will be based on:

- Theme or Slogan
 - Originality/creativity
 - Clarity
 - Carry through
- Promotion of Organization, club, and/or Ottawa County Fair
 - Club name identified
 - Members and projects identified
 - Club purpose conveyed
- Attractiveness
 - Projects and props arranged well
 - Space filled, but not crowded
 - Artistic use of colors and materials

OTTAWA CO. JR. FAIR KING AND QUEEN CONTEST

Monday July 14th, 2025

A royal court consisting of a King, Queen, and 1st/2nd Runners-Up will represent the 2025 Ottawa County Jr. Fair during the week of fair and throughout the year at various activities and events, including Ohio fairs, festivals, and parades.

Eligibility:

1. Anyone **ages 16-18** as of January 1st, 2025 who is a participant in the Ottawa County Jr. Fair Program through 4-H, FFA, DECA, FCCLA, Girl Scouts, or Boy Scouts and believes their community involvement and leadership endeavors warrant recognition as a model Jr. Fair participant.
2. Applicants must not be, nor have been married or pregnant, nor have fathered a child.
3. Applicants must be free of past or present use of illegal substances, including alcohol.
4. Applicants must never have been convicted of a criminal offense nor have criminal charges pending.
5. Previous title holders of Fair King or Queen are ineligible to compete again in the future.

Judging Rules and Criteria:

1. Applicants must submit a **photo, cover letter, résumé (with reference page), and essay** via email to the King & Queen Superintendent (Sara Soltis: SaraSoltis77@gmail.com) by July 1, 2025 at midnight. Late applications will not be accepted.
 2. Contestants will receive email confirmation of application submission within 24 hours (if confirmation has not been received within 24 hours, please call Sara at (419) 707-2113). Contestants can expect an email with detailed information covering next steps from Sara within one week of the application deadline.
3. Judges will interview contestants the evening of Wednesday July 9th.
4. The new court will be crowned Monday July 14th in the Genoa Bank Pavilion.
5. Members of the new court are expected to maintain the dress and poise of the title at all times during their reign. Failure to comply with the guidelines provided to contestants and their parent/guardian prior to the contest will result in the forfeit of the title and all awards (including crown/sash).
6. All decisions of the judges will be final.



2024 Ottawa Co. Jr. Fair Royalty

Judges scoring will be based on the following criteria for a total of 100 points:

Criteria	Components	Point Value
Submitted Application	Cover Letter: <i>Neatness, Grammar, Appeal</i>	5
	Resume: <i>1-page with focus on Jr. Fair and other leadership activities</i>	20
	Reference Page: <i>List 3 References (include phone number of 1 teacher and 2 influential adults – no relatives).</i>	15
	Essay: <i>1-page, double-spaced essay that answers: "I should be chosen to represent the Ottawa County Fair as King or Queen because..."</i>	10
Interview	Personal Interview	25
	Public Interview/On Stage Presence	25

Ottawa Co. Jr. Fair Coordinator and King & Queen Superintendent reserves the right to interpret these rules

All interpretations by these authorities are final

2025 OTTAWA CO. JR. FAIR BRED, BORN & RAISED VERIFICATION FORM

Use one form for each animal that you are entering into BBR Market Class

Exhibitor: _____

Club: _____

Parent(s): _____

Phone Number: _____

Animal's Ear Tag: _____ Animal's Birth Date: _____

Color or identifying marks: _____

Breeder: _____

Breeder's Address: _____

Breeder's Phone Number: _____

In reference to the above-described animal and/or its dam, I certify that the following statements are true:

- I had ownership of the dam of the above-described animal at the time of service
- I maintained ownership of the dam until the sale of the above-described animal the animal was calved on my farm in Ottawa County, or I am an Ottawa County junior fair exhibitor, and the animal was calved on my farm
- I sold the above-described animal directly to the above listed exhibitor
- To the best of my knowledge, since the date of sale to the above-named exhibitor, the animal has been raised in Ottawa County or on that exhibitor's farm.

Date of Sale: _____ Breeder's Signature: _____

Date: _____

To the best of my knowledge, all information on this page is accurate, and I understand that my animal(s) will not be eligible for the Ottawa County Born, Bred, and Raised competition at the Ottawa County Junior Fair if any of the above stated information is found to be false.

Exhibitor's Signature: _____ Date: _____

Parent's Signature: _____ Date: _____

(Signature of parent required if exhibitor is less than 18 years of age.)

You must turn this form into your barn superintendent during the check-in process on move-in Sunday of fair week to be eligible for the show!

Removal of Project from the Sale Form

Removal of Project from the Sale Form

PLEASE COMPLETE ONE (1) FORM PER ANIMAL
FORM MUST BE COMPLETED AND TURNED INTO SUPERINTENDENT WITHIN TWO (2)
HOURS FOLLOWING THE SHOW

Exhibitors Name: _____

Please check one (1)

Beef Steer / Market Heifer

- Beef/Dairy Feeder
- Hog
Sheep
- Goat

Please complete ALL boxes.

Complete Animal ID	Color of Animal	Sex of Animal

Reason for Removing Animal

- Pulling for State Fair (**MUST** attach the Ohio State Fair proof of registration)
- Going Back to the Farm (Feeder and Dairy Calves ONLY)

Please indicate the removal time of the animal:

- At the conclusion of the Ottawa County Fair
- The time period after the show designated by each species

Exhibitor Signature _____ Date _____

Parent Signature _____

Signature of Superintendent _____

Date and Time received _____

Sale Committee Member _____

Date and Time received _____